



(12) **United States Patent**  
**Larose et al.**

(10) **Patent No.:** **US 11,297,906 B2**  
(45) **Date of Patent:** **Apr. 12, 2022**

(54) **FLEXIBLE BAND CLASP WITH COMMUNICATION DEVICE**  
(71) Applicant: **Endur ID, Inc.**, Hampton, NH (US)  
(72) Inventors: **Albert Larose**, Dracut, MA (US);  
**Robert Chadwick**, Hampton Falls, NH (US)  
(73) Assignee: **Endur ID, Inc.**, Hampton, NH (US)  
(\* ) Notice: Subject to any disclaimer, the term of this patent is extended or adjusted under 35 U.S.C. 154(b) by 0 days.

(58) **Field of Classification Search**  
CPC ..... Y10T 24/45194; Y10T 24/4995; A44B 11/2592; A44B 11/06; A44B 99/00; G09F 3/005; B65B 61/202; F16B 5/0692; A61F 5/3776  
See application file for complete search history.

(21) Appl. No.: **16/678,690**  
(22) Filed: **Nov. 8, 2019**  
(65) **Prior Publication Data**  
US 2020/0146401 A1 May 14, 2020

(56) **References Cited**  
U.S. PATENT DOCUMENTS  
2,586,758 A 2/1952 Zerr  
3,935,977 A 2/1976 Bonnett  
4,049,357 A 9/1977 Hamisch, Jr.  
4,416,038 A 11/1983 Morrone, III  
4,635,698 A 1/1987 Anderson  
5,208,950 A 5/1993 Merritt  
(Continued)

**Related U.S. Application Data**  
(60) Provisional application No. 62/757,778, filed on Nov. 9, 2018, provisional application No. 62/841,405, filed on May 1, 2019.

**OTHER PUBLICATIONS**  
Minew Technologies. Beacon/iBeacon/MiniBeacon Datasheet V1.0 technical specification sheet.  
*Primary Examiner* — Robert Sandy  
*Assistant Examiner* — Michael S Lee  
(74) *Attorney, Agent, or Firm* — Onello & Mello, LLP

(51) **Int. Cl.**  
**A44B 11/25** (2006.01)  
**A44B 11/02** (2006.01)  
**A44C 5/24** (2006.01)  
**H04W 4/80** (2018.01)  
**G09F 3/00** (2006.01)  
(52) **U.S. Cl.**  
CPC ..... **A44B 11/02** (2013.01); **A44B 11/25** (2013.01); **A44C 5/24** (2013.01); **G09F 3/005** (2013.01); **H04W 4/80** (2018.02)

(57) **ABSTRACT**  
A clasp is configured to permanently interlock around a flexible strip of material and includes first and second interlocking members. At least one interlocking member includes a Bluetooth communication device. Each interlocking member can include a plurality of hooks and a corresponding plurality of recesses, where the recesses of one interlocking member receive the hooks of the other interlocking member to secure a band within the clasp between the interlocking members. The recesses can be completely internal to the clasp to prevent external tampering. Each of the interlocking members can include various protrusions and ribs that compress and secure the band within the clasp, so as to prevent movement of the band between the interlocking members when interlocked.  
**18 Claims, 28 Drawing Sheets**

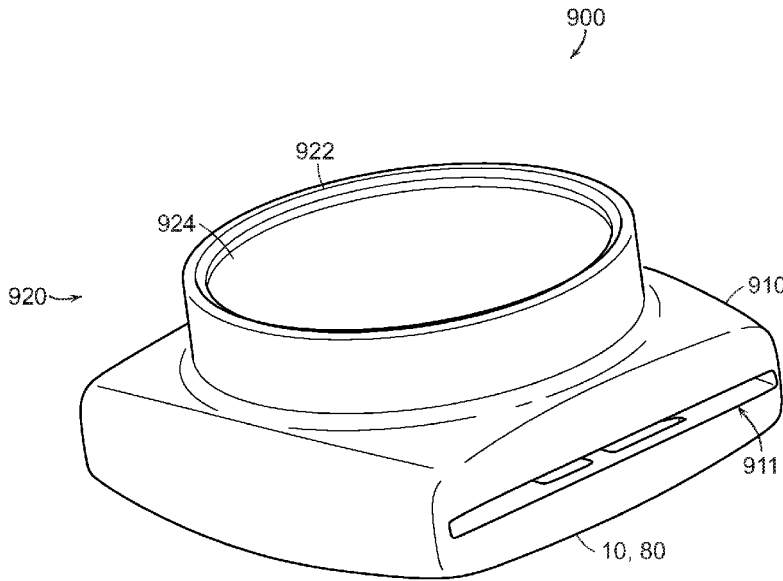

(56)

References Cited

U.S. PATENT DOCUMENTS

5,381,617	A	1/1995	Schwartztol et al.	9,730,495	B2	8/2017	Howell	
5,473,797	A	12/1995	Wu	10,188,176	B2	1/2019	Chadwick	
5,495,644	A	3/1996	Meshher et al.	10,441,037	B2	10/2019	Chadwick	
5,548,878	A	8/1996	Romagnoli	2002/0088095	A1	7/2002	Hahn	
5,577,395	A	11/1996	Kuykendall	2003/0217441	A1	11/2003	Eaton et al.	
5,671,508	A	9/1997	Murai	2005/0091801	A1	5/2005	Feschuk	
5,689,860	A	11/1997	Matoba et al.	2005/0166436	A1	8/2005	Girvin et al.	
6,453,519	B1	9/2002	Gelardi	2006/0042151	A1	3/2006	Kavanaugh	
6,510,592	B1	1/2003	Hamilton	2006/0196016	A1	9/2006	Cai et al.	
6,565,049	B2	5/2003	Hahn	2009/0255101	A1	10/2009	Lin	
6,571,434	B2	6/2003	Ortiz	2013/0091668	A1	4/2013	Turdjian	
6,618,910	B1	9/2003	Pontaoe	2013/0097824	A1	4/2013	Chadwick	
6,826,806	B2	12/2004	Eaton et al.	2015/0128384	A1	5/2015	Breen, IV et al.	
7,237,307	B2	7/2007	Feschuk	2015/0173666	A1*	6/2015	Smith	A61B 5/682
7,367,092	B1	5/2008	Dilday					600/301
7,406,789	B2	8/2008	Story	2015/0378391	A1*	12/2015	Huitema	G09F 9/301
7,450,014	B2*	11/2008	Farhadian					361/679.03
7,614,179	B2	11/2009	Kavanaugh	2016/0088905	A1	3/2016	Perry	
9,339,408	B2	5/2016	Chadwick	2016/0157564	A1	6/2016	Howell	
9,555,943	B2	1/2017	Breen, IV et al.	2016/0219987	A1	8/2016	Chadwick	
9,622,546	B2	4/2017	Turdjian	2016/0283086	A1*	9/2016	Inagaki	G06F 1/163
				2017/0162006	A1*	6/2017	Sahadi	H04L 67/306
				2017/0224063	A1	8/2017	Chadwick	
				2019/0286956	A1*	9/2019	Webster	G06K 19/0727

\* cited by examiner

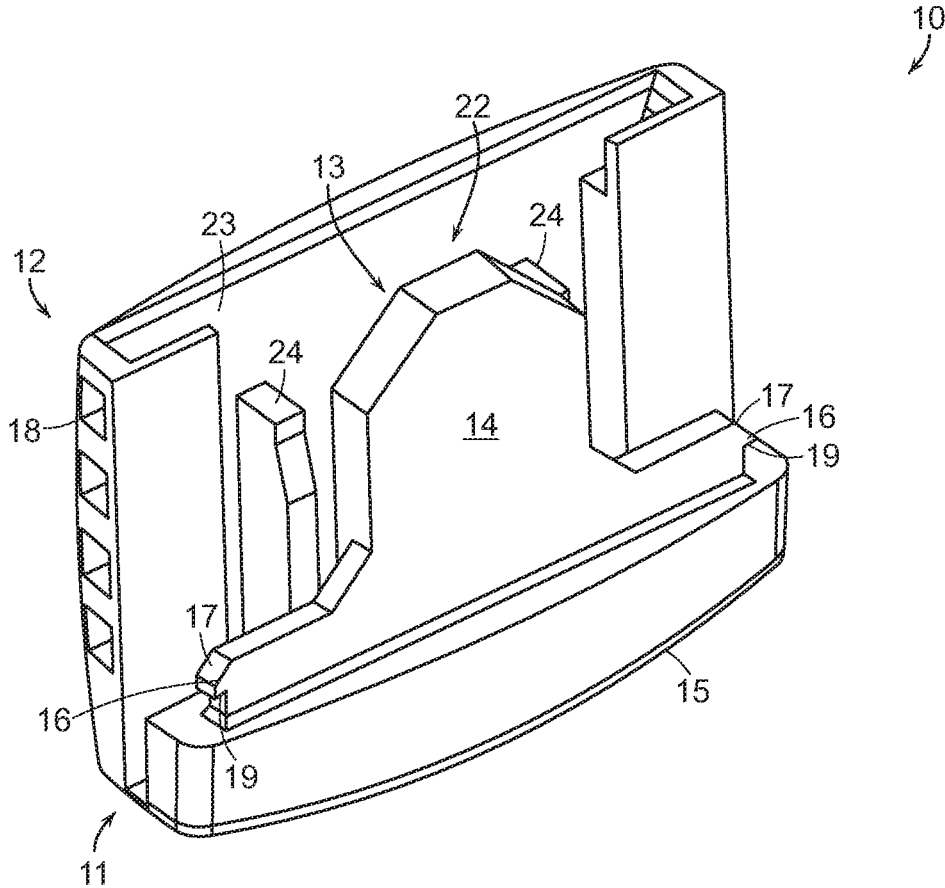

FIG. 1A

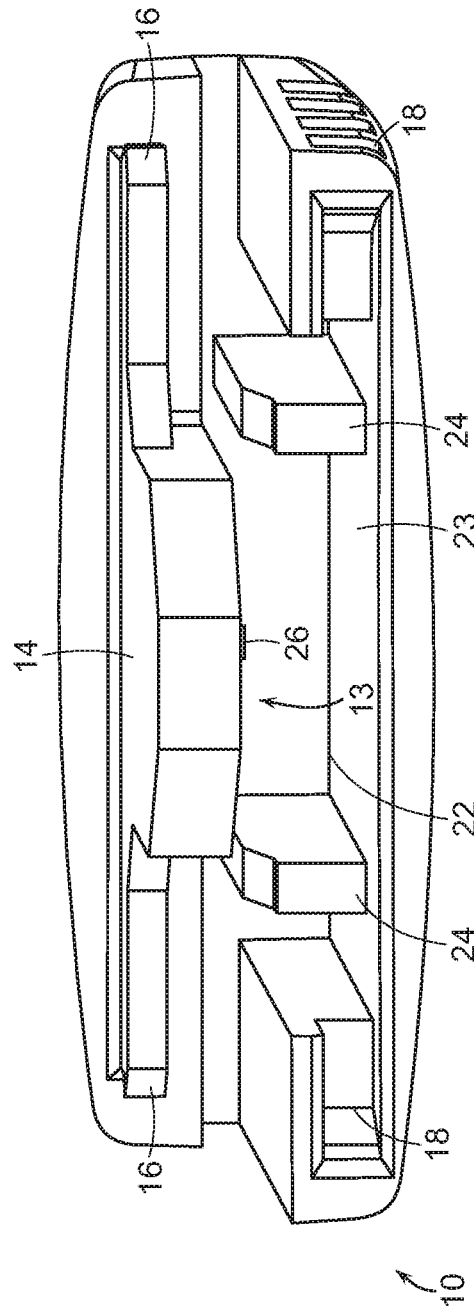

FIG. 1B

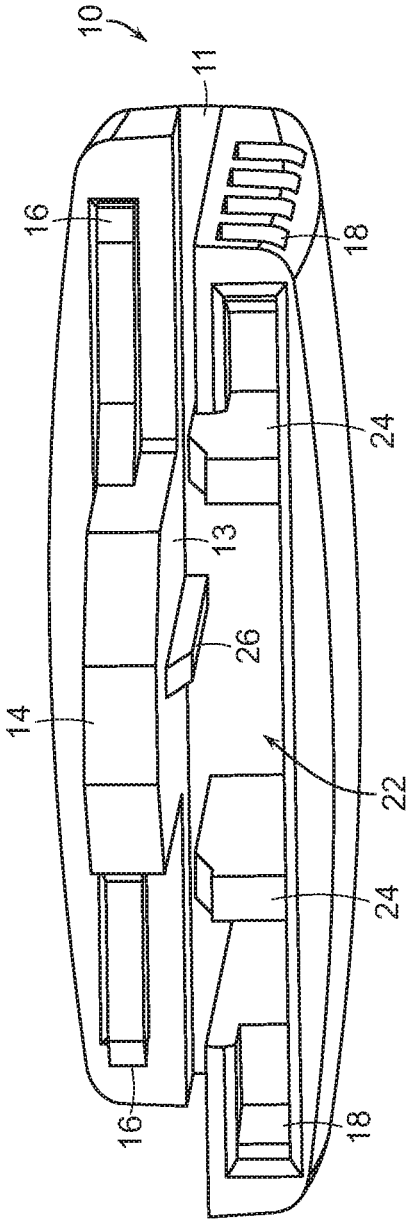

FIG. 10

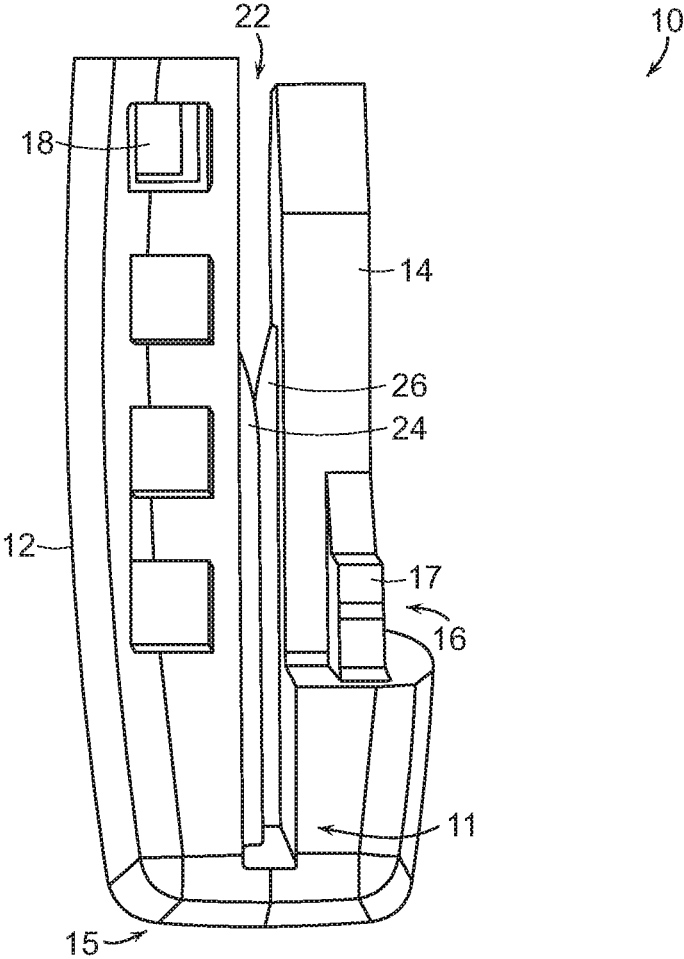

FIG. 1D

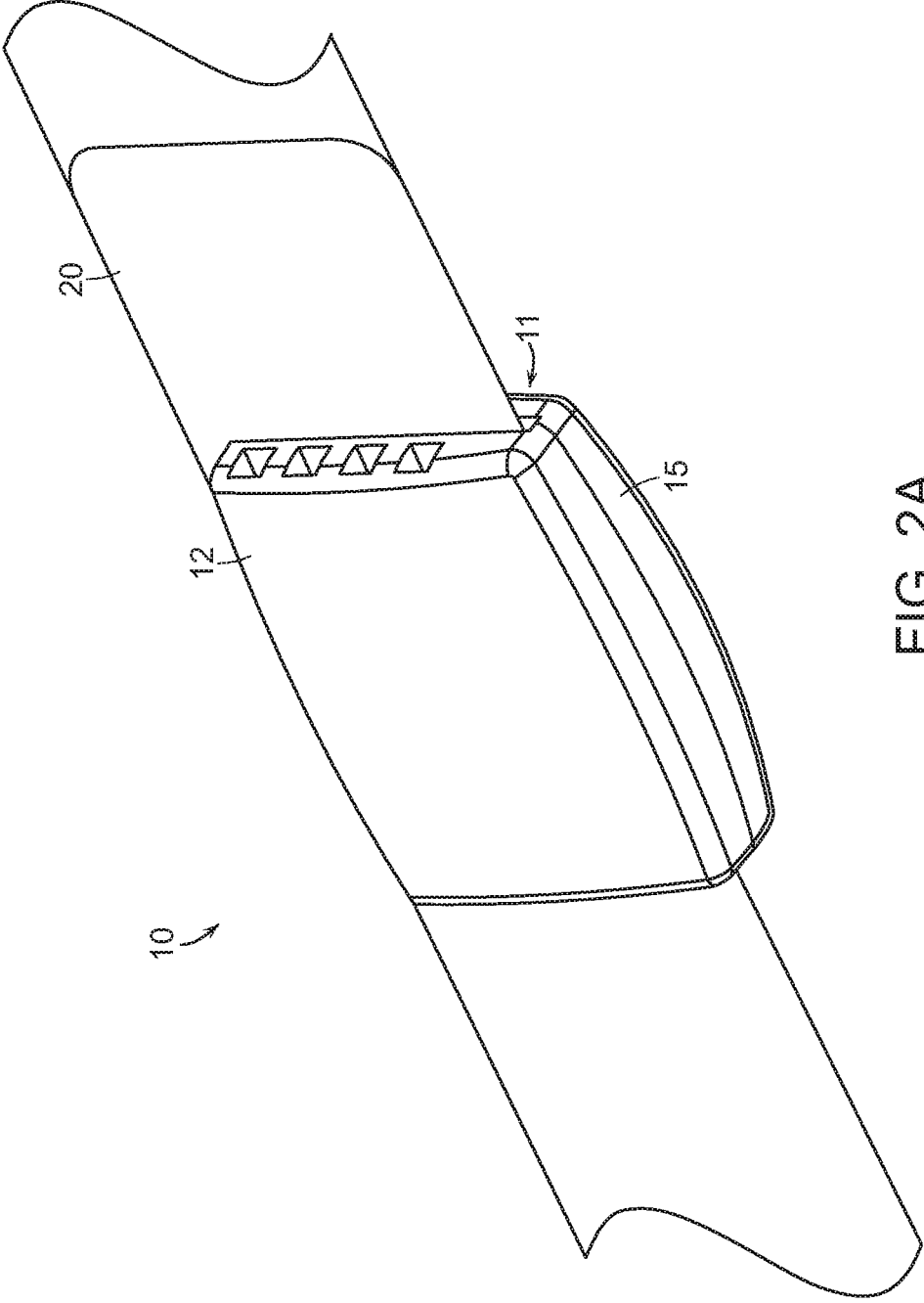

FIG. 2A

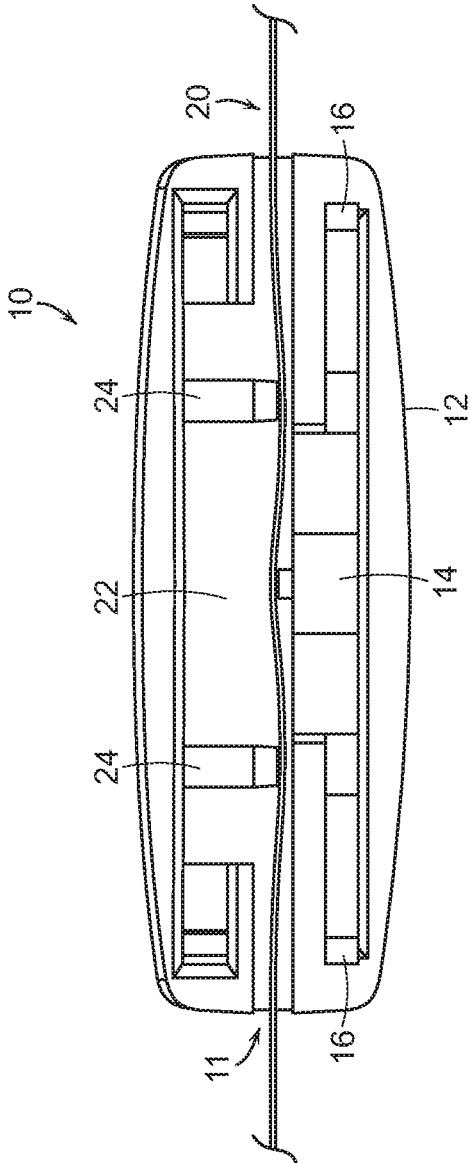

FIG. 2B

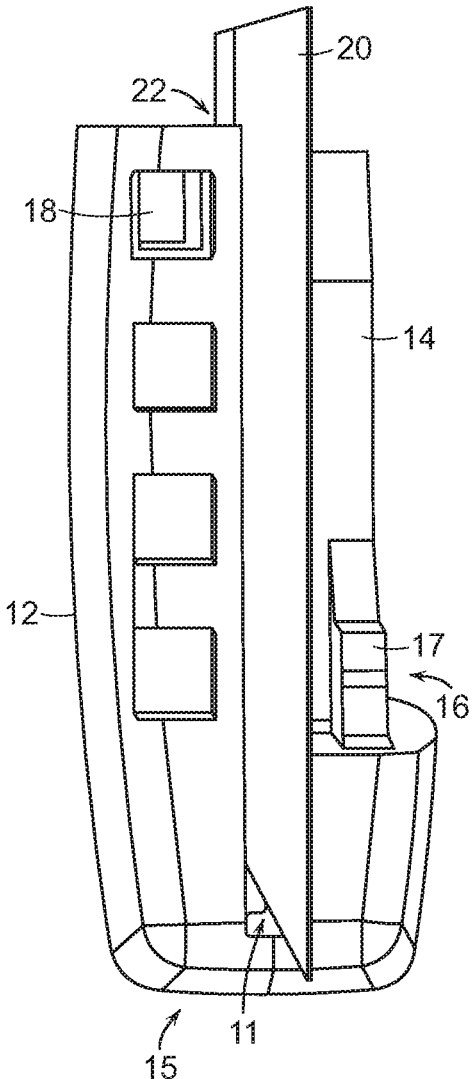
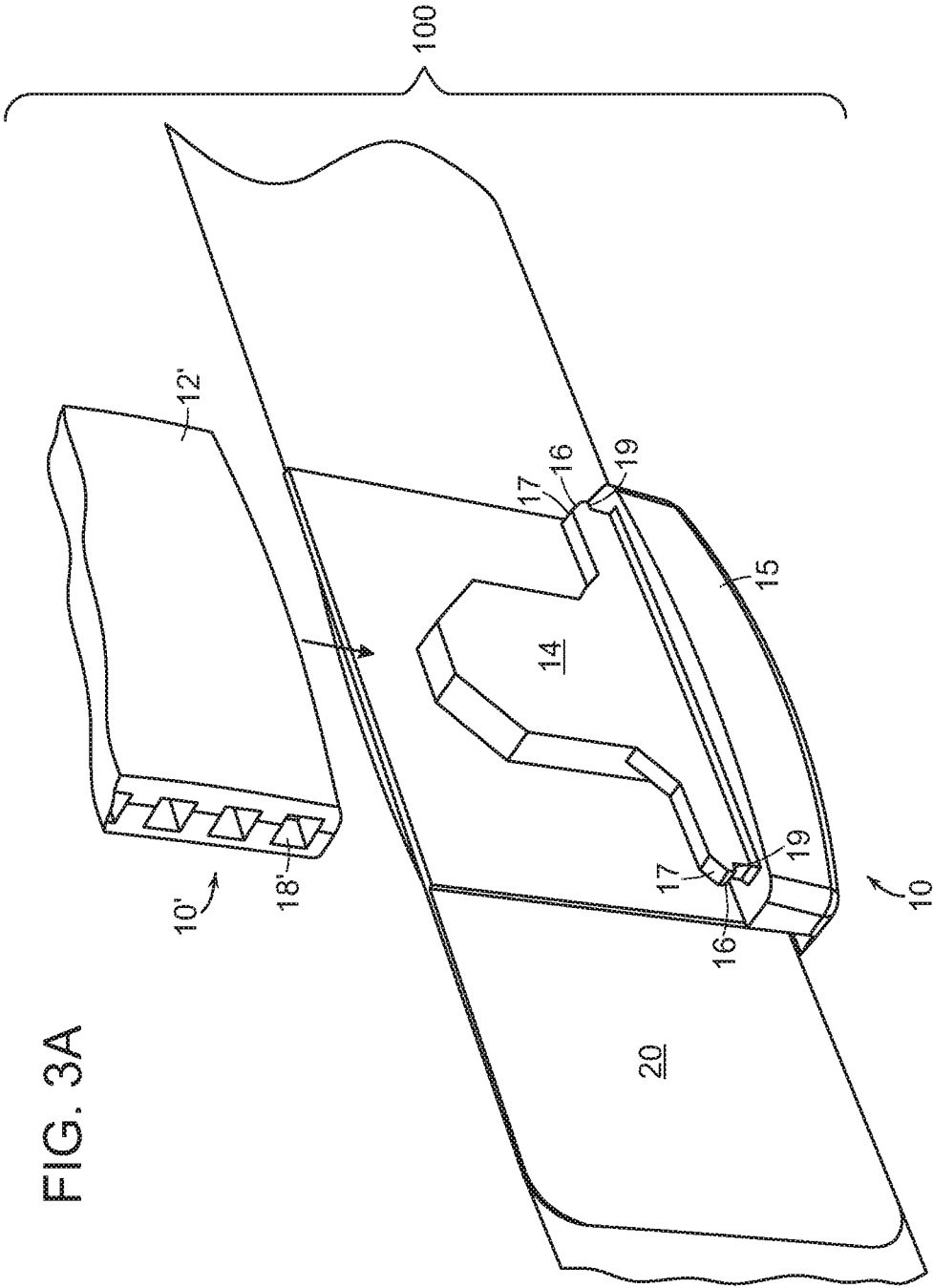
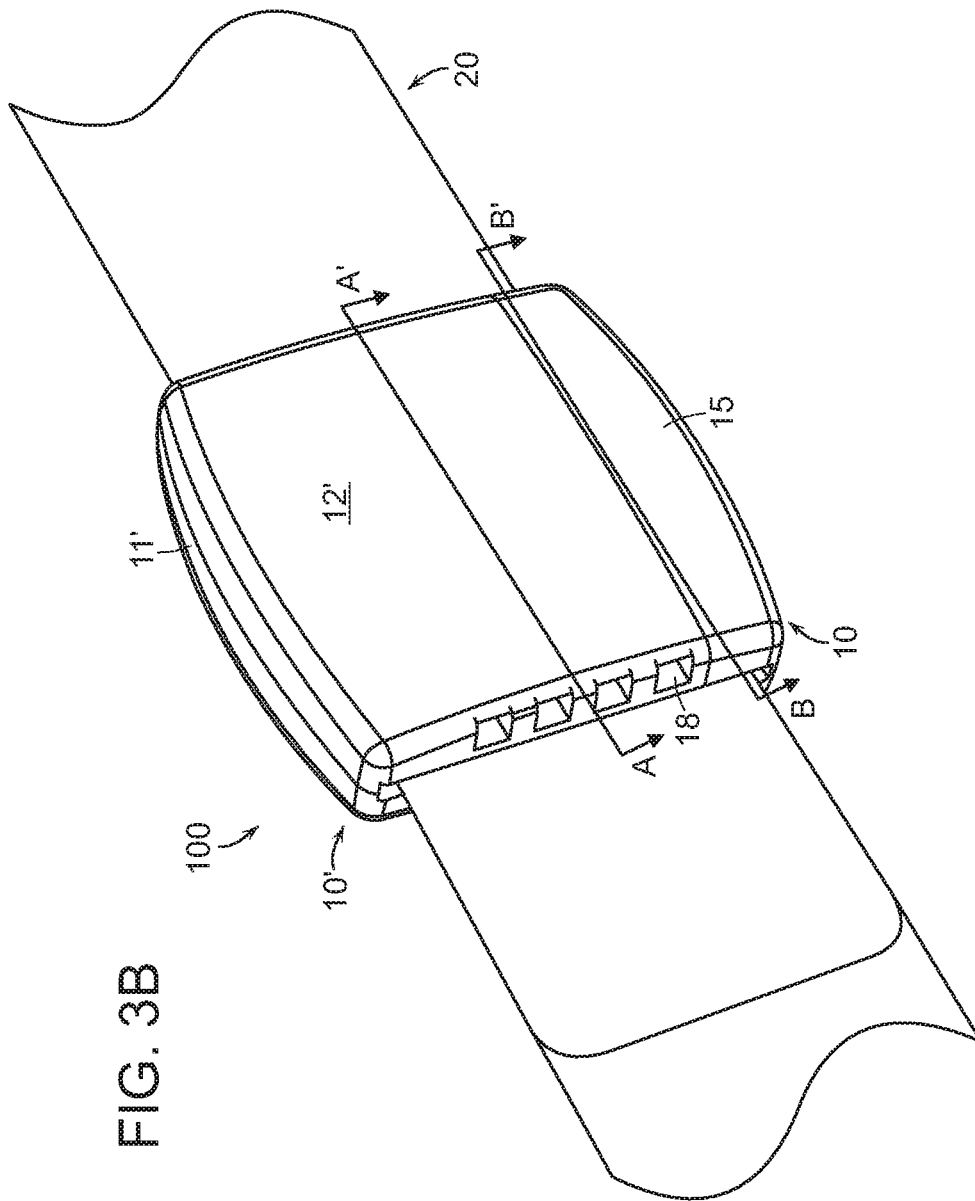

FIG. 2C





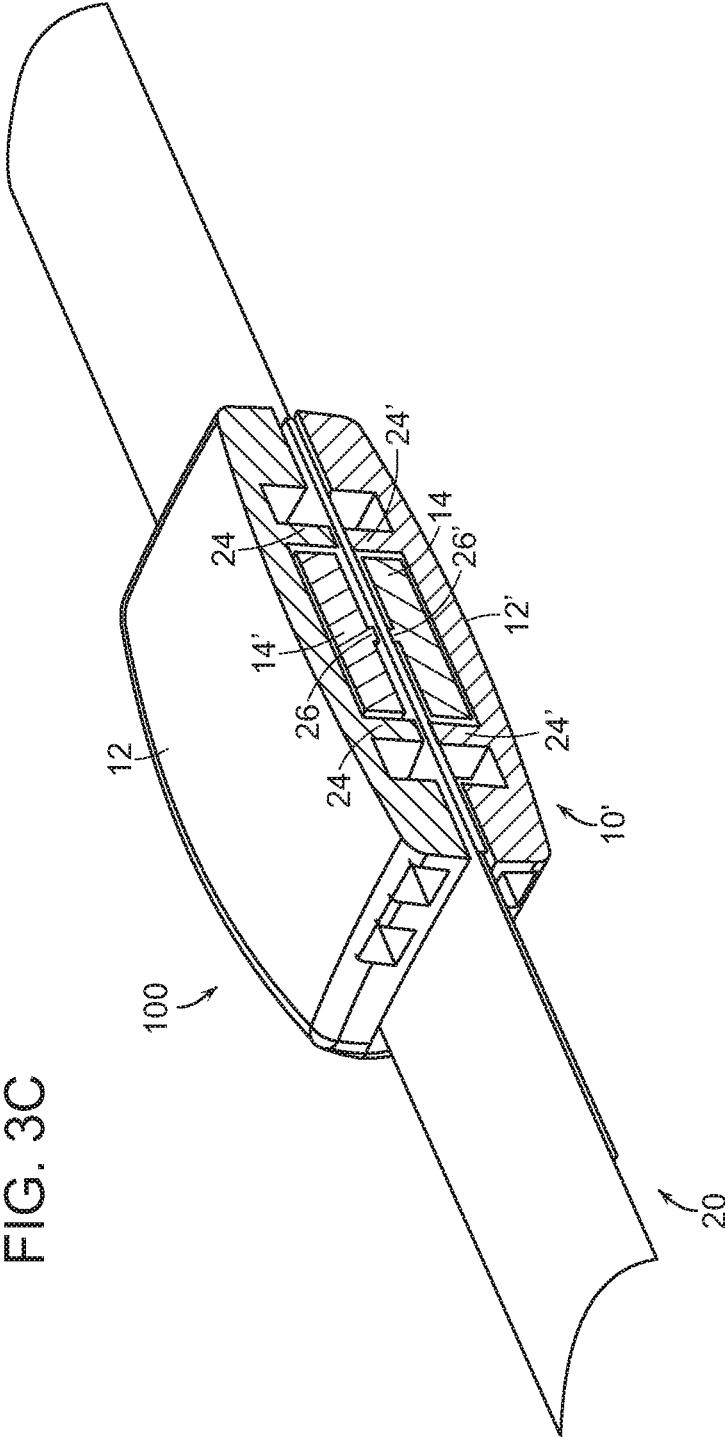

FIG. 3C

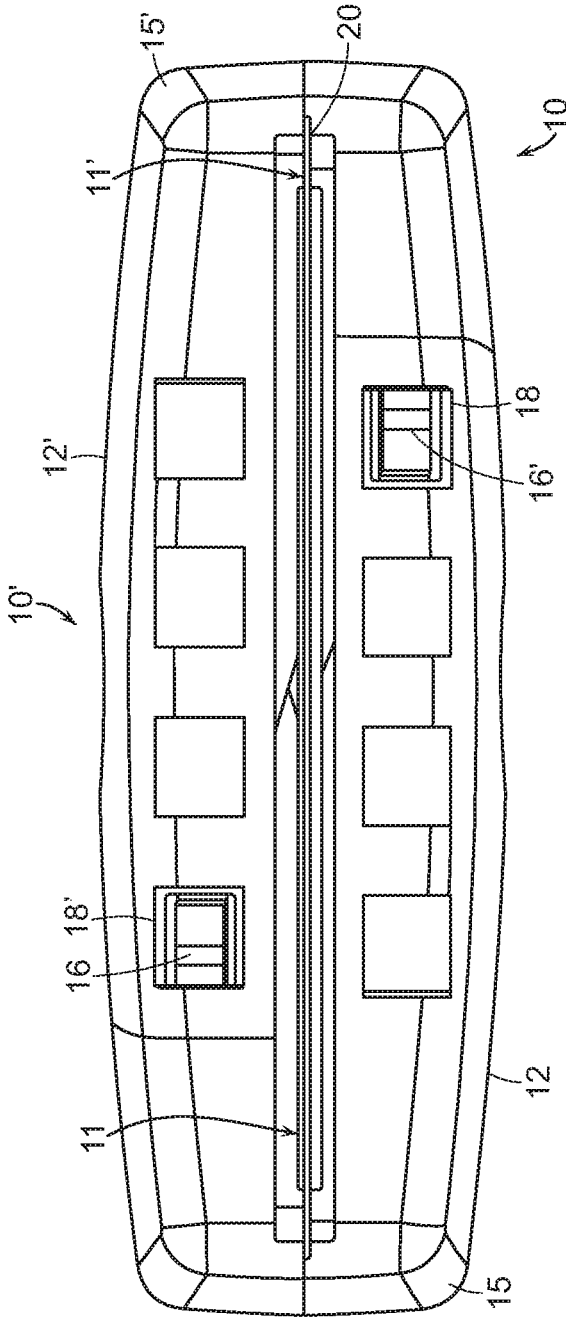

FIG. 3D

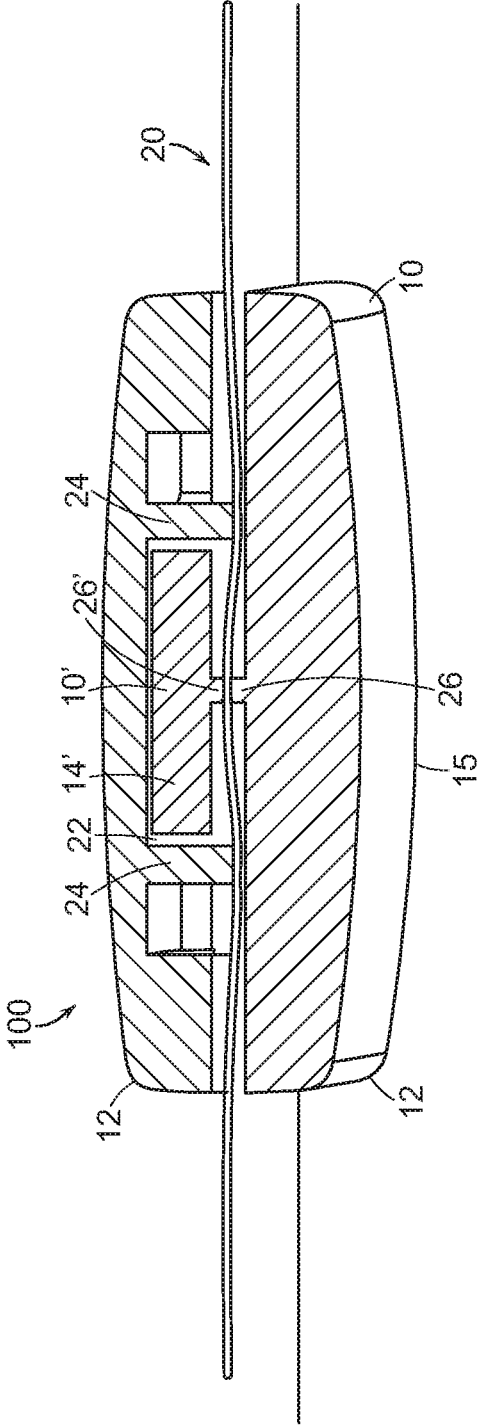

FIG. 3E

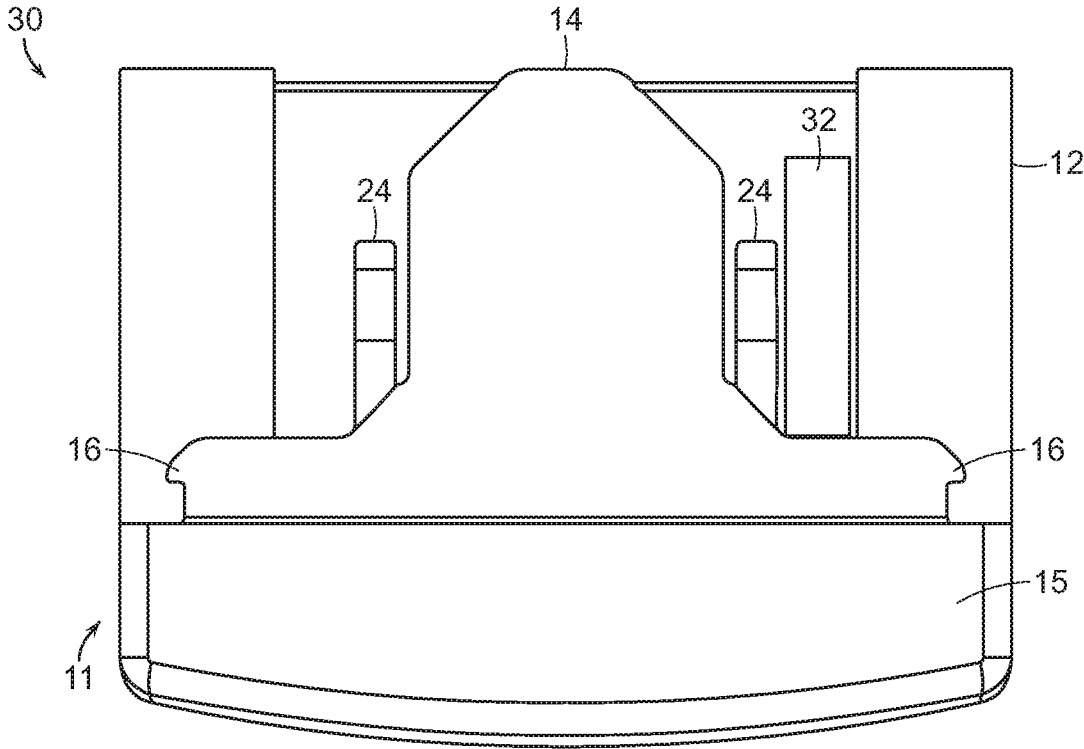

FIG. 4A

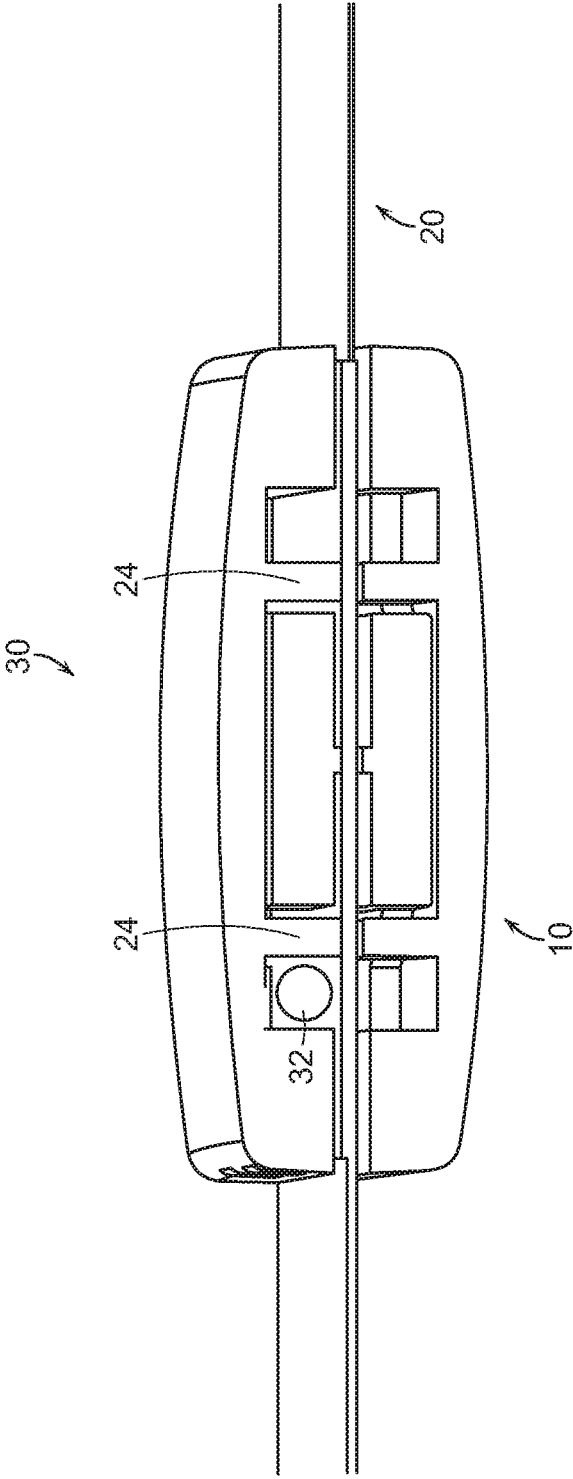

FIG. 4B

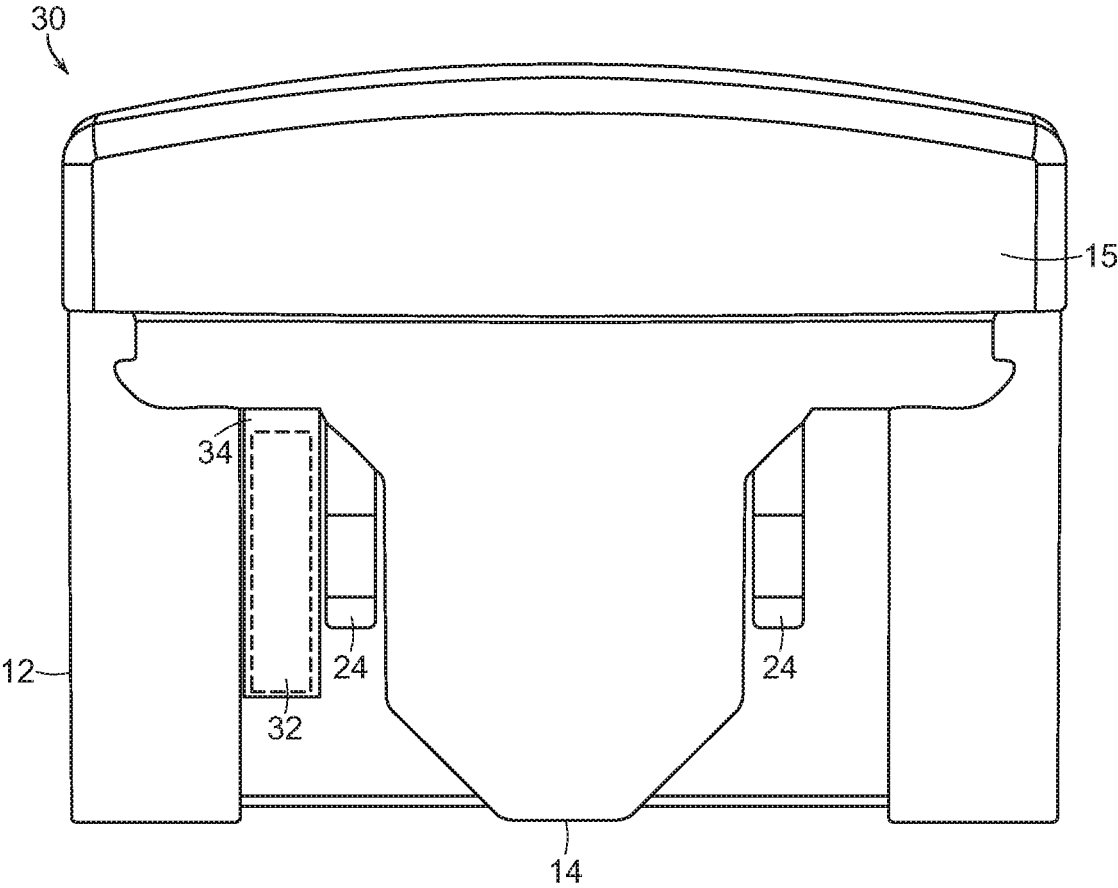

FIG. 5A

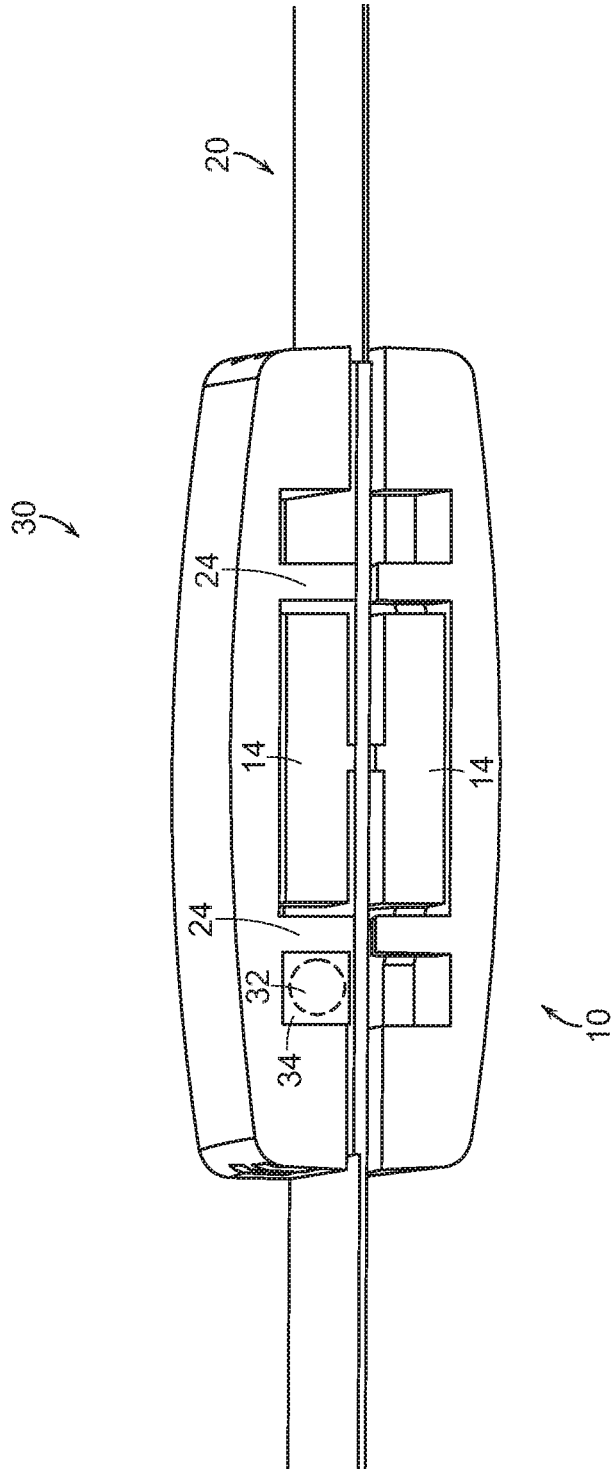

FIG. 5B

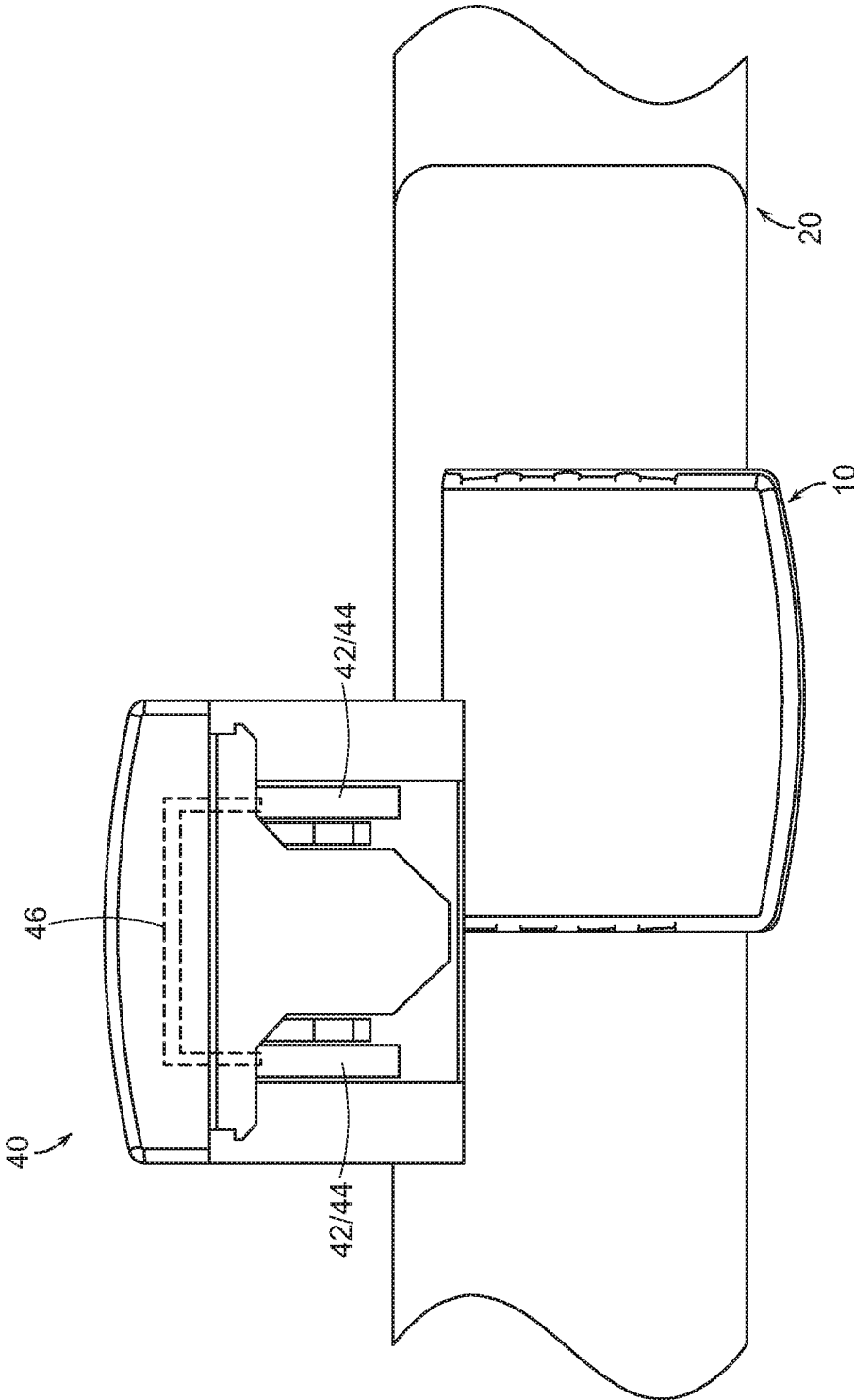

FIG. 6A

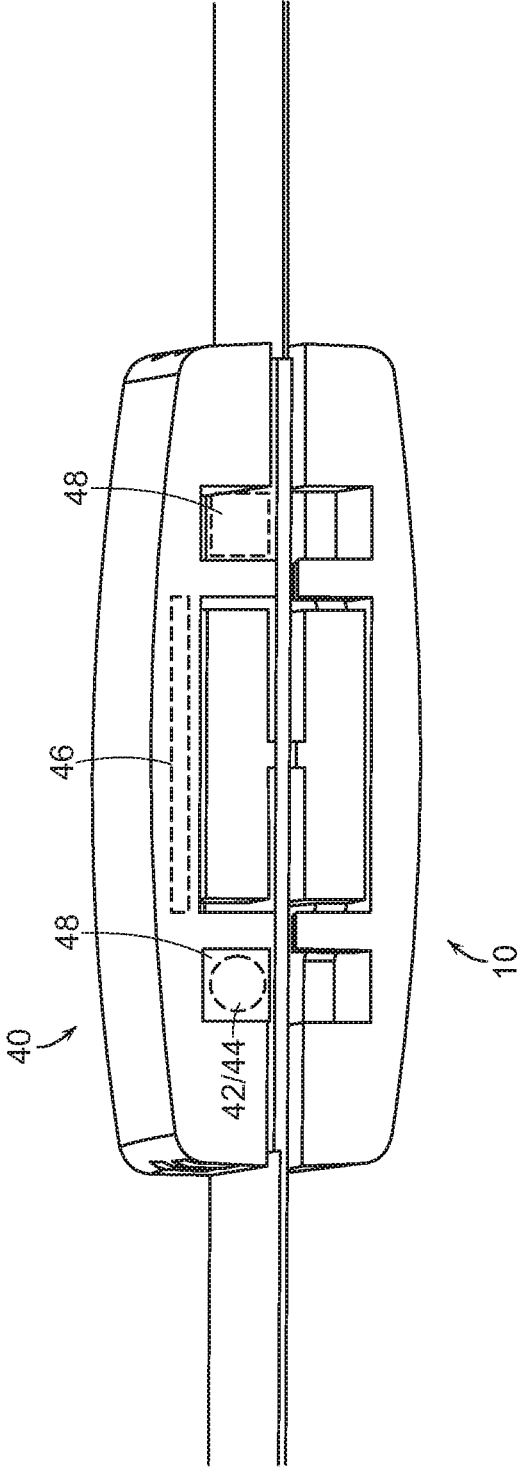

FIG. 6B

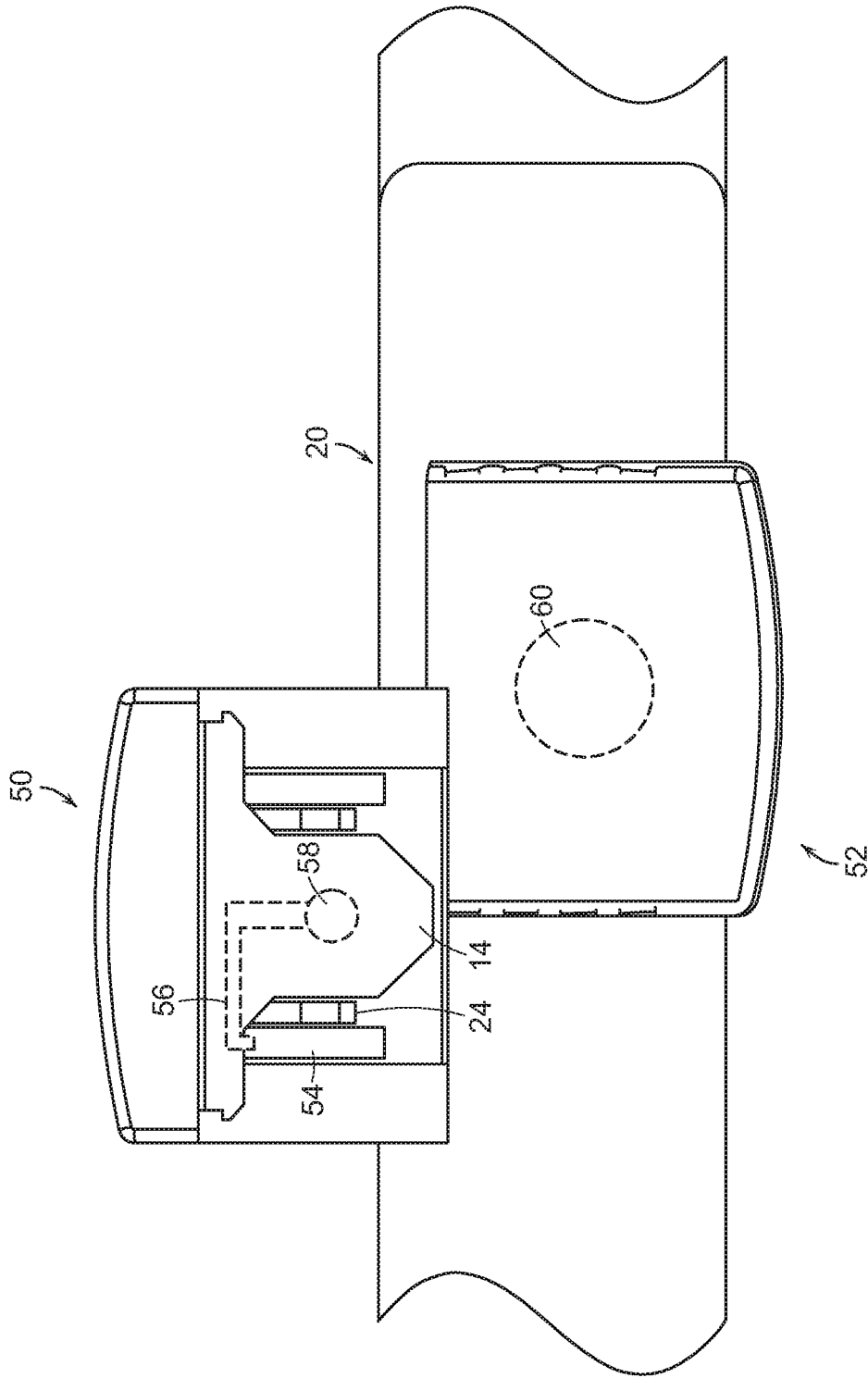

FIG. 7A

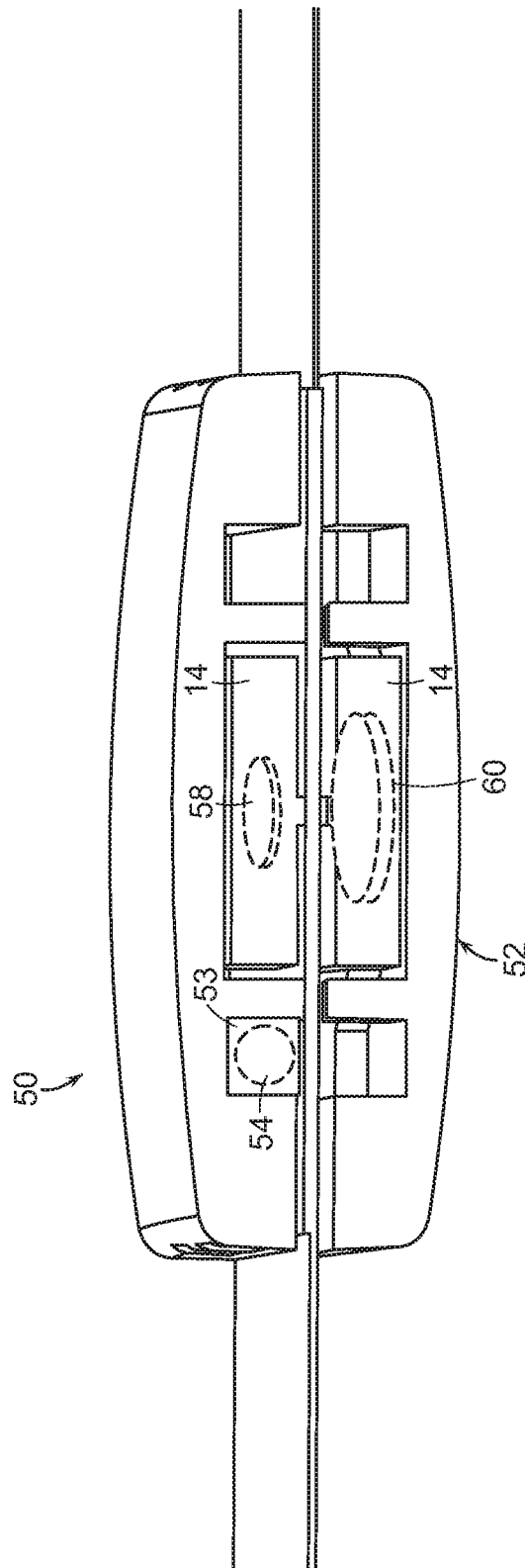

FIG. 7B

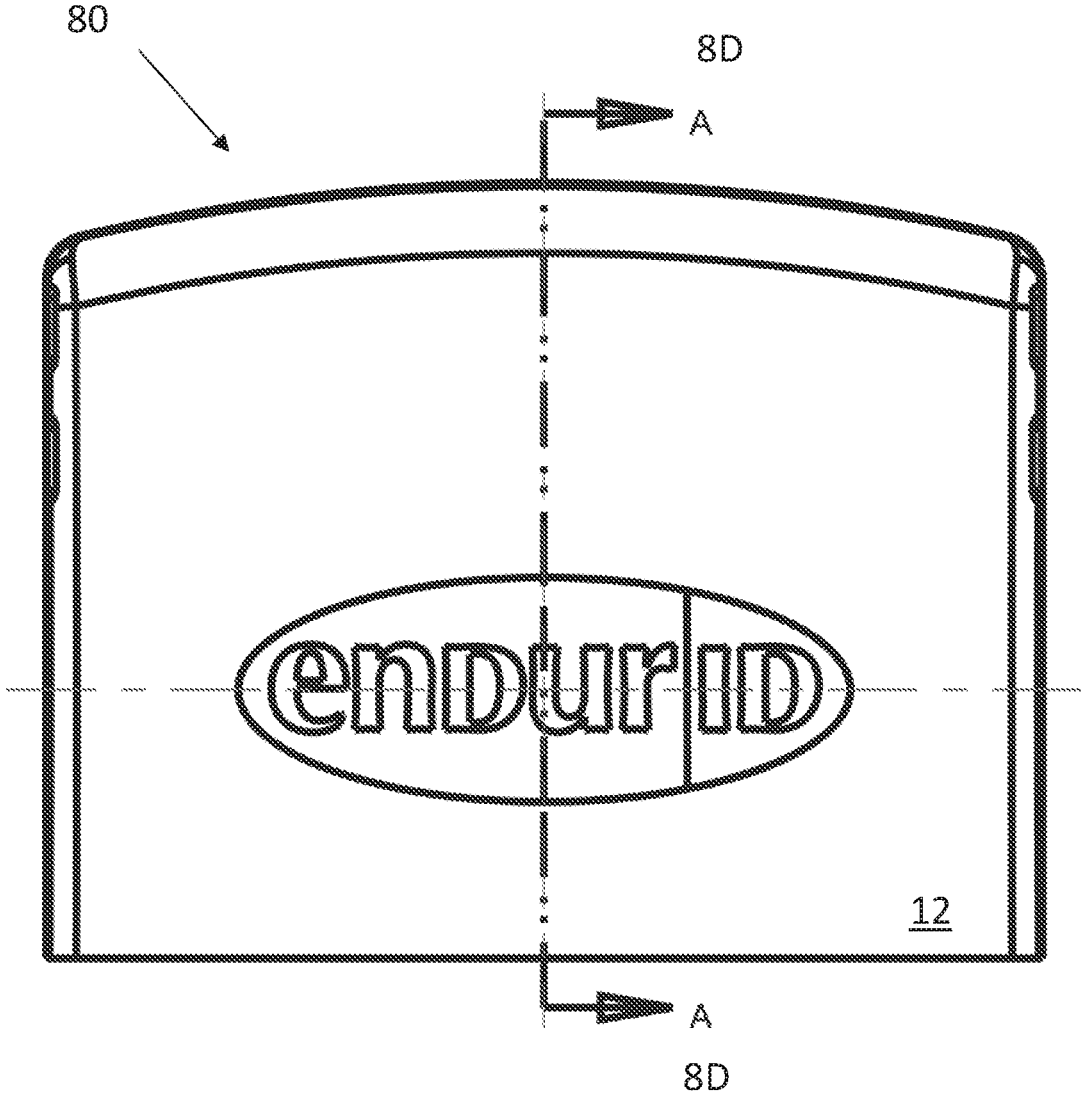

FIG. 8A

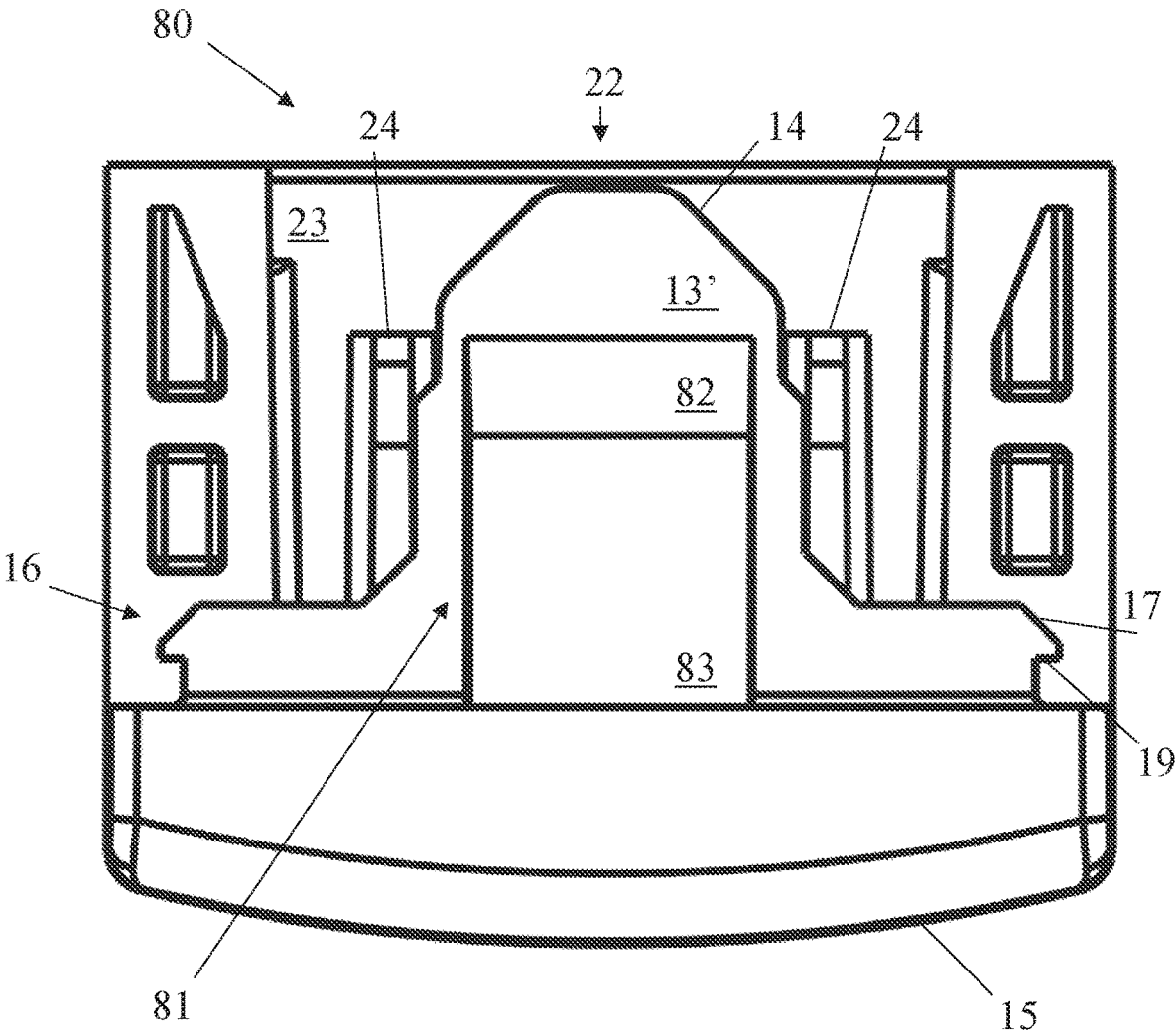

FIG. 8B

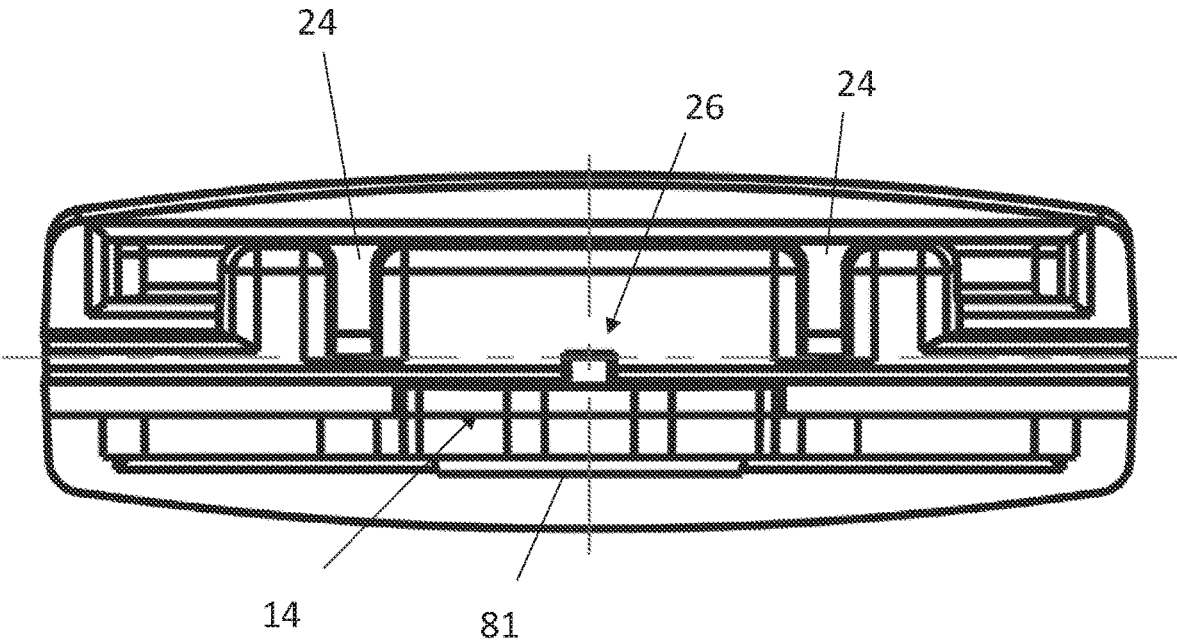

FIG. 8C

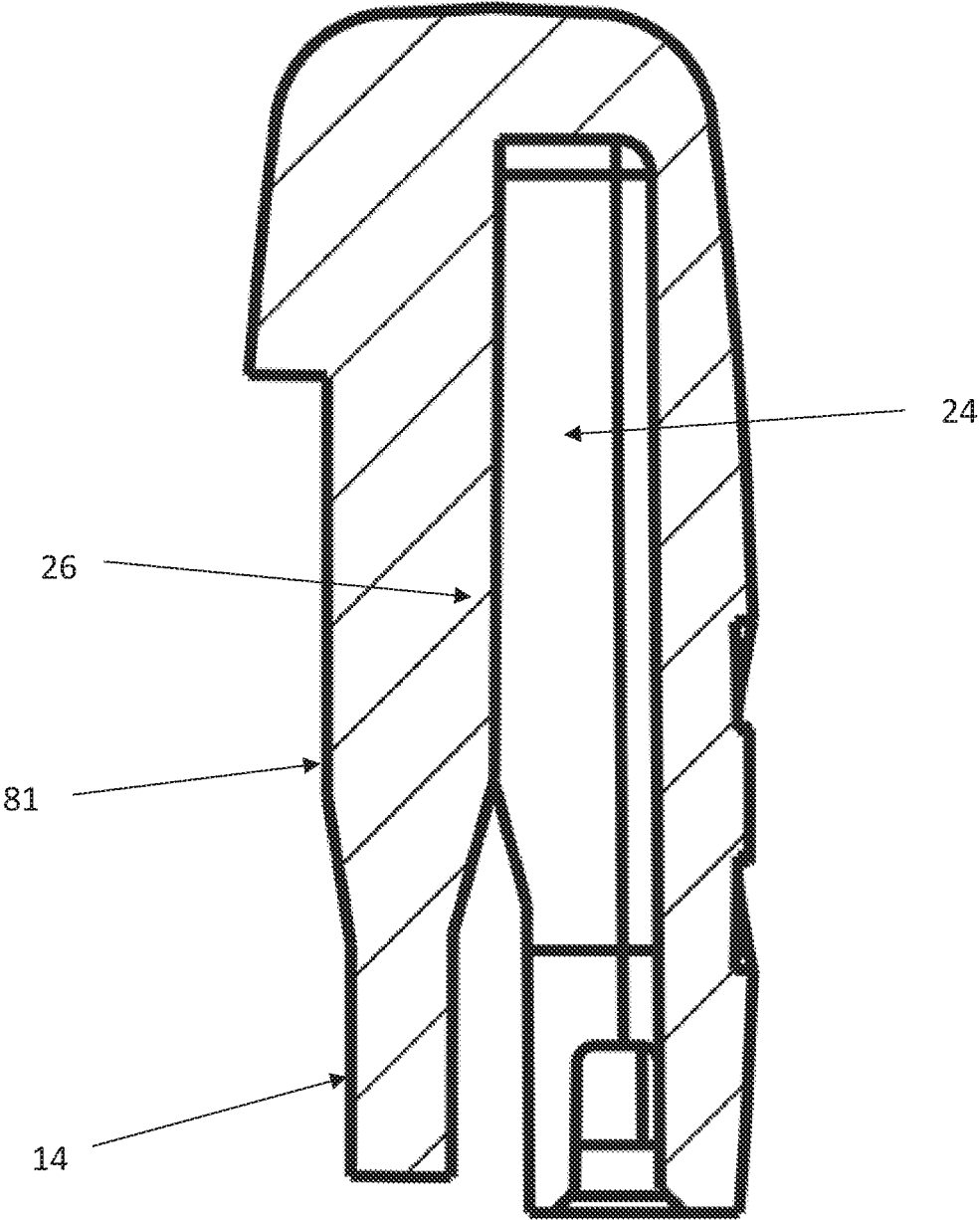

FIG. 8D

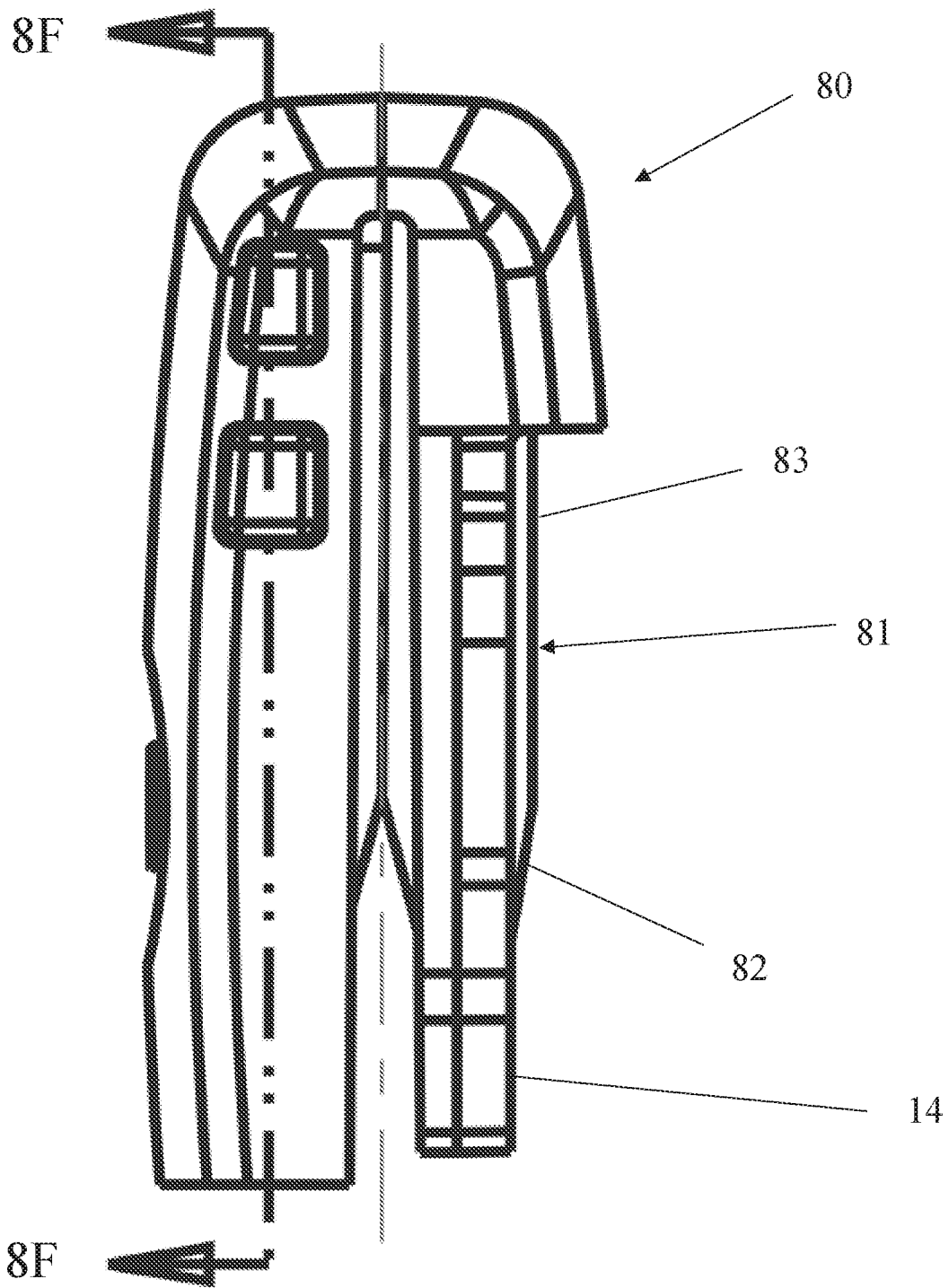

FIG. 8E

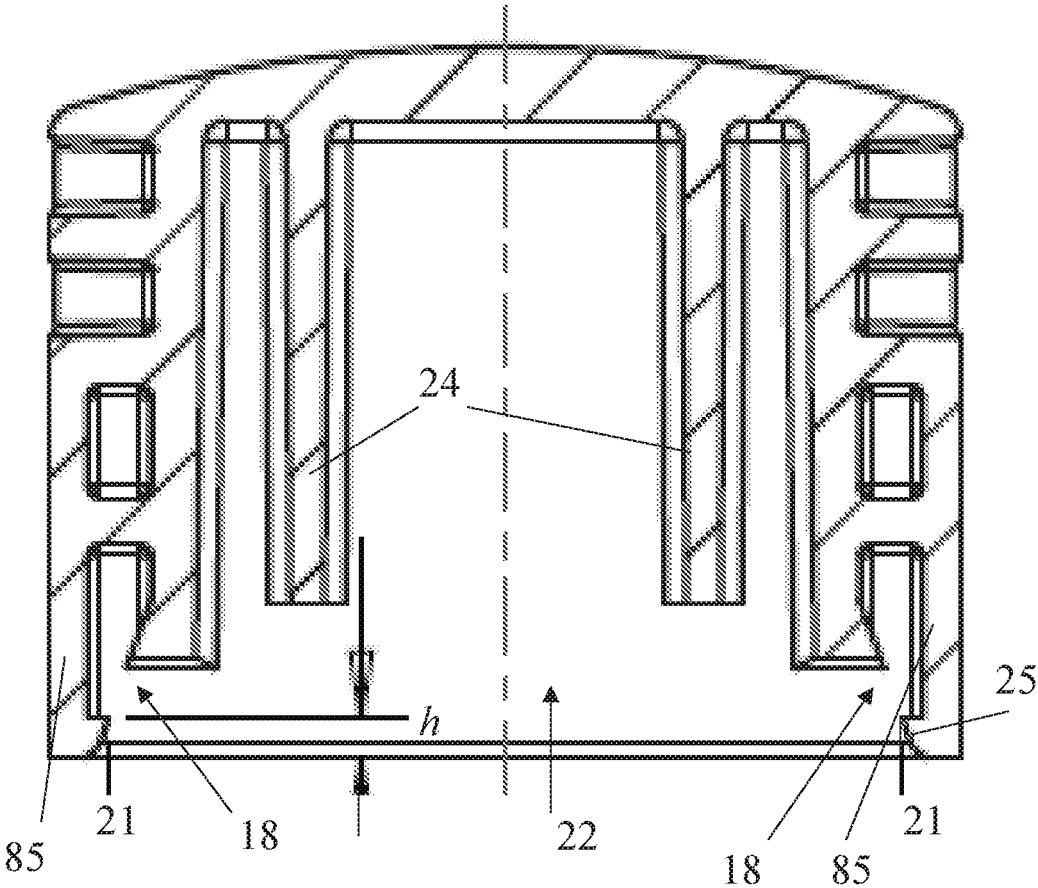

FIG. 8F

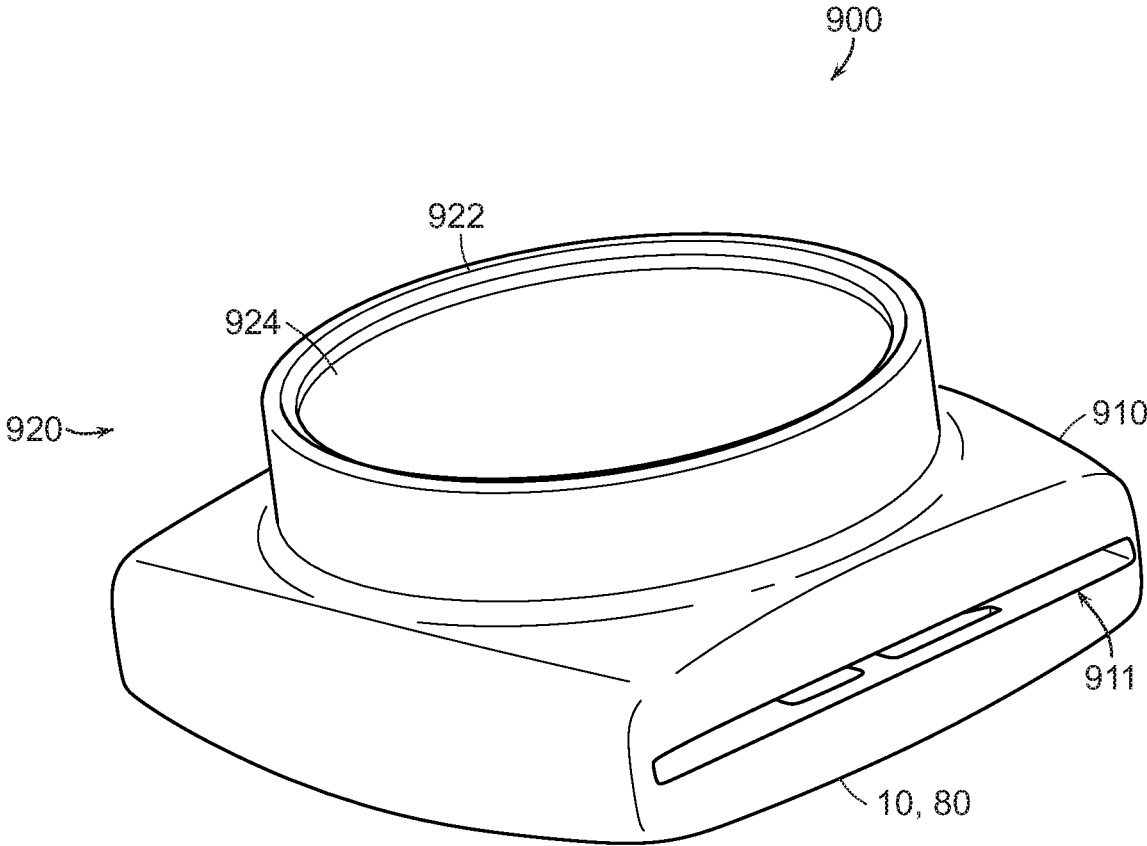

FIG. 9

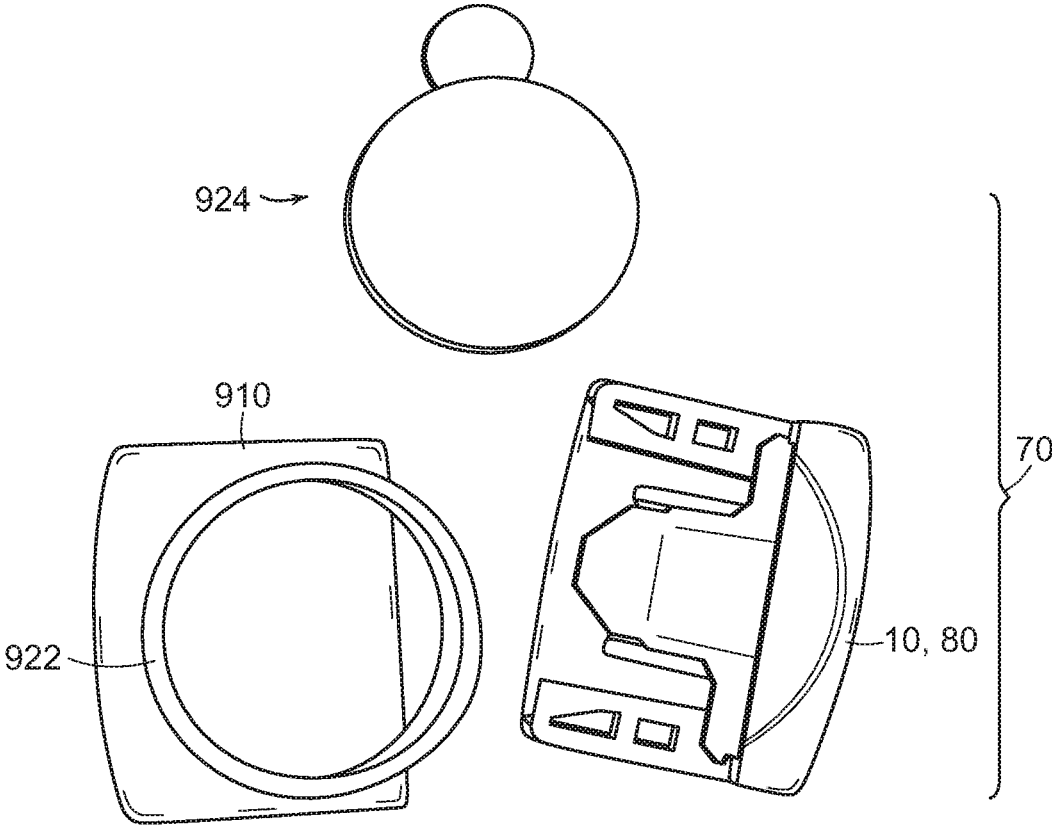

FIG. 10A

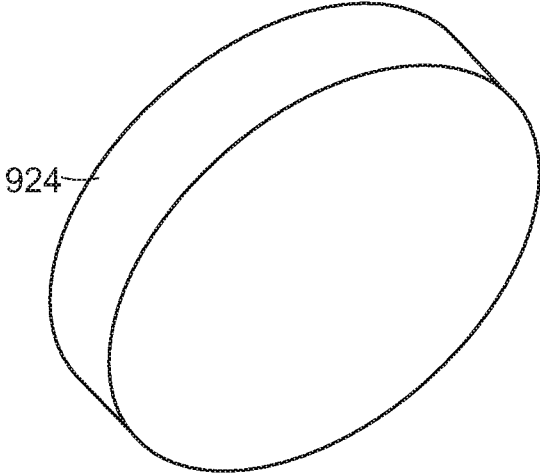

FIG. 10B

**FLEXIBLE BAND CLASP WITH  
COMMUNICATION DEVICE**

## RELATED APPLICATIONS

This application claims the benefit of U.S. Provisional Application No. 62/757,778, filed Nov. 9, 2018 and U.S. Provisional Application No. 62/841,405 filed May 1, 2019, the content of which are incorporated herein by reference in their entirety.

This application, while not claiming priority to, may be considered related to U.S. Pat. No. 8,177,777 filed Apr. 23, 2010, U.S. Pat. No. 8,091,261 filed on Jun. 17, 2009, U.S. Pat. No. 9,339,408 filed on Oct. 19, 2012, U.S. Pat. No. 10,188,176 filed on Apr. 13, 2016, and U.S. Pat. No. 10,441,037 filed on Apr. 26, 2017.

## FIELD

Embodiments of inventive concept relate to clasps for securing flexible bands, such as identification bands, and their methods of use and manufacture.

## BACKGROUND

Flexible bands including, for example, wrist straps and bundled fiber/cable ribbons, can be exposed to external factors which compromise their connecting ends. For example, an identifying wrist strap on a patient is generally attached at its ends with an adhesive portion or unsecure interlocking feature, and the removal of the band at the resulting seam can be caused by accidental or intentional dismantling by the patient or others.

## SUMMARY

As used herein, the terms “band” and “flexible band” may refer to any of the various flexible materials disclosed herein, or other flexible materials not specifically mentioned herein.

A clasp or closure is provided for enclosing/protecting a flexible band and, in an example embodiment, for securing the connecting ends of one or more bands. Some example embodiments provide identical mechanically interlocking members of a clasp that can be placed around a portion of a strap, including the connected ends (or seam) of one or more bands. The clasp may be configured to prevent slippage of the strap(s) within the clasp and protect an enclosed seam, for example, from being disconnected by external factors, such as a wearer of a band.

According to one aspect of the inventive concept, a clasp is configured to permanently interlock around a flexible strip of material. In one example embodiment, the clasp includes first and second interlocking members, each interlocking member including two hooks and two recesses, each of the hooks of the first member arranged to engage and interlock with one of the recesses of the second member and each of the hooks of the second member arranged to interlock with one of the recesses of the first member, so as to prevent movement between the interlocking members when interlocked. When interlocked, the clasp may also prevent movement or slippage of the flexible strip of material.

According to another aspect of the inventive concept, a clasp is provided that is configured to permanently interlock around a flexible strip of material. In one example embodiment, the clasp includes first and second interlocking members, each interlocking member including an outer shell

having interlocking recesses formed therein, a tongue having interlocking hooks, and a tongue receiving slot formed between the tongue and the outer shell, wherein, when the first and second interlocking members are interlocked, the tongue of one interlocking member fits within the tongue receiving slot of the other interlocking member and the hooks of one interlocking member engage the interlocking recesses of the other interlocking member, thereby preventing disengagement of the interlocking members.

In some example embodiments, the first and second interlocking members are identically formed pieces.

In some example embodiments, the interlocking members are arranged so that, once engaged and interlocked, the clasp is permanently closed.

In some example embodiments, the clasp includes an inner surface forming a portion of the tongue receiving slot, including internal ribs protruding from the inner surface and forming opposing sides of the tongue receiving slot.

In some example embodiments, the tongues are arranged so that when the first and second interlocking members are interlocked, they define a path configured to compress and secure the flexible strip to substantially prevent movement within the clasp.

In some example embodiments, the tongues further include protrusions extending from a tongue inner surface forming a portion of the tongue receiving slot, the protrusions configured to substantially prevent sliding of the flexible strip between the interlocking members when interlocked.

In some example embodiments, each interlocking member further includes a base from which the outer shell and tongue extend substantially in parallel.

In some example embodiments, the tongue of each interlocking member is configured to slidably engage the tongue receiving slot of the other interlocking member.

In some example embodiments, when the first and second interlocking members are interlocked, a portion of the flexible strip of material is disposed between and in parallel with the tongues and outer shells of the first and second interlocking members.

In some example embodiments, the clasp is arranged to enclose and prevent access to a seam of the flexible strip of material. In some embodiments, the flexible strip of material is a flexible wrist strap or band.

In some example embodiments, the strip of material comprises at least one of a strip of cables, plastic, and fibers.

In some example embodiments, the clasp is constructed substantially of plastic, resin and/or metal.

In some example embodiments, each interlocking hook comprises an angled member configured to facilitate insertion into a corresponding interlocking recess and a stop member configured to prohibit removal of the interlocking hook from the corresponding interlocking recess.

An interlocking member, comprising a shell including a base, a tongue extending from the base, a tongue receiving slot defined between the tongue and the shell, and a positive interlocking mechanism and a negative interlocking mechanism. The interlocking member is configured to interlock with a second interlocking member to form a clasp configured to permanently secure a flexible band.

According to another aspect of the inventive concept, a method of enclosing and protecting a flexible strip of material is provided, the method including enclosing the flexible strip of material within a clasp. In an embodiment, enclosing the flexible strip of material within a clasp includes engaging and interlocking first and second members of the clasp about the flexible strip of material, the

engaging and interlocking of the first and second members including interlocking two hooks of the first member with two corresponding recesses of the second member and engaging and interlocking two hooks of the second member with two corresponding recesses of the first member.

According to another aspect of the inventive concept, a method of permanently securing a flexible strip of material is provided. The method includes providing a clasp comprising first and second interlocking members. In an embodiment, each interlocking member includes an outer shell having interlocking recesses formed therein and a tongue having interlocking hooks, and a tongue receiving slot formed between the tongue and the outer shell. In an embodiment, the method includes disposing a portion of the flexible strip of material within the tongue receiving slot of the first interlocking member and interlocking the second interlocking member with the first interlocking member, including positioning the tongue of one interlocking member within the tongue receiving slot of the other interlocking member and forcing the hooks of one interlocking member within the interlocking recesses of the other interlocking member, so as to prevent disengagement of the interlocking members.

In accordance with some aspects of the inventive concept, provided is a method of permanently securing a flexible band. The method comprises providing a clasp comprising first and second interlocking members. Each interlocking member comprises a shell including a base, a tongue extending from the base, a tongue receiving slot defined between the tongue and the shell, and a positive interlocking mechanism and a negative interlocking mechanism. The method further comprises disposing a flexible band in a channel passing through the tongue receiving slot of the first interlocking member and permanently combining the second interlocking member with the first interlocking member.

In some example embodiments, the first and second interlocking members are identically formed pieces.

In some example embodiments, the interlocking members are engaged and interlocked to permanently close the clasp.

In some example embodiments, interlocking the first and second members of the clasp about the flexible strip of material substantially prevents slippage of the flexible strip of material within the clasp.

In some example embodiments, the method includes enclosing a seam of the flexible strip of material within the clasp by interlocking the first and second members of the clasp about the connecting portions of the flexible strip of material. In some embodiments, the flexible strip of material is a wrist or ankle band.

In some example embodiments, positioning the tongue of one interlocking member within the tongue receiving slot of the other interlocking member includes slidably engaging the tongue of each interlocking member into the tongue receiving slot of the other interlocking member.

In some example embodiments, each interlocking member further includes a base from which the outer shell and tongue extend substantially in parallel.

In some example embodiments, interlocking the first and second interlocking members includes irremovably securing a portion of the flexible strip of material between and in parallel with the tongues and outer shells of the first and second interlocking members.

In some example embodiments, the tongues further comprise protrusions extending from a tongue inner surface forming a portion of the tongue receiving slot, the protrusions configured to reduce sliding of the flexible strip between the interlocking members when interlocked.

In some example embodiments, each outer shell includes an inner surface forming a portion of the tongue receiving slot, including internal ribs protruding from the inner surface and forming opposing sides of the tongue receiving slot.

In some example embodiments, when the first and second interlocking members are interlocked, they define a path configured to compress and secure the flexible strip to substantially prevent movement within the clasp.

In some example embodiments, an interlocking member includes a shell including a base, a tongue extending from the base in parallel with the shell, including a raised portion on a top surface of the tongue, a tongue receiving slot defined between the tongue and the shell, and a positive interlocking mechanism and a negative interlocking mechanism, wherein, when interlocked, a positive interlocking mechanism of one interlocking member permanently interlocks with a negative interlocking mechanism of a second interlocking member and the tongue of each interlocking member is locked within the tongue receiving slot of the other interlocking member and the tongues are positioned to secure a band between the tongues.

In accordance with another aspect of the inventive concept, provided is a clasp configured to permanently secure a flexible band, comprising first and second interlocking members. Each interlocking member comprises: a shell including a base; a tongue extending from the base in parallel with the shell, including at least one tongue protrusion extending from a tongue back surface toward the shell; a tongue receiving slot defined between the tongue and the shell, and within which the tongue protrusion extends; and at least one hook and at least one recess, each recess configured to receive a hook from another interlocking member and having a wall configured to prevent external access to the hook received within the recess. When interlocked, the first and second interlocking members define a path from one side of the clasp to an opposite side of the clasp through which the flexible band passes such that the flexible band extends through a first opening in the one side of the clasp and a second opening in the opposite side of the clasp and the flexible band is compressed by and between the tongue protrusions of the tongues of the first and second interlocking members.

In some example embodiments, when interlocked, the clasp defines an internal serpentine path between the tongues that compresses and secures the flexible band.

In some example embodiments, the first and second interlocking members are identical.

In some example embodiments, the at least one hook consists of two hooks and the at least one recess consists of two recesses configured to permanently receive the two hooks of the other interlocking member.

In some example embodiments, each hook comprises an angled side configured to facilitate insertion into a corresponding recess and a stop side configured to prohibit removal of the hook from the corresponding recess.

In some example embodiments, the at least one hook is at least one outwardly projecting protrusion of the tongue and the at least one recess is formed in outer portions of the shell.

In some example embodiments, each shell comprises an inner surface opposite the tongue and forming a portion of the tongue receiving slot and at least two ribs extending from the inner surface and forming opposing sides of the tongue receiving slot, wherein the tongue of each of the first and second interlocking members is configured to slidably engage the tongue receiving slot of the other interlocking member.

5

In some example embodiments, at least one of the first and second interlocking members comprises a radio frequency identification (RFID) chip.

In some example embodiments, the flexible band is a flexible strip of material.

In some example embodiments, the tongue of at least one of the first and second interlocking members further includes a tongue biasing member on a front surface of the tongue extending away from the shell.

In accordance with another aspect of the inventive concept, provided is an interlocking member forming a portion of a clasp configured to secure a band. The interlocking member comprising a shell including a base; a tongue extending from the base in parallel with the shell, including at least one tongue protrusion extending from a tongue back surface toward the shell; a tongue receiving slot defined between the tongue and the shell, and within which the tongue protrusion extends; and at least one hook and at least one recess, each recess configured to receive a hook from another interlocking member and having a wall configured to prevent external access to the hook received within the recess. The interlocking member is configured to interlock with a second interlocking member to form a clasp configured to permanently secure a flexible band passing through the clasp from one side to an opposite side, wherein a portion of the flexible band is compressed within the tongue receiving slot.

In some example embodiments, when interlocked, the clasp defines an internal serpentine path between the tongues that compresses and secures the flexible band.

In some example embodiments, the at least one hook consists of two hooks and the at least one recess consists of two recesses configured to permanently receive two hooks of the second interlocking member.

In some example embodiments, each hook comprises an angled side configured to facilitate insertion into a corresponding recess of the second interlocking member and a stop side configured to prohibit removal of the hook from the corresponding recess of the second interlocking member.

In some example embodiments, the at least one hook is at least one outwardly projecting protrusion of the tongue and the at least one recess is formed in outer portions of the shell.

In some example embodiments, the shell comprises an inner surface opposite the tongue and forming a portion of the tongue receiving slot and at least two ribs extending from the inner surface and forming opposing sides of the tongue receiving slot.

In some example embodiments, the tongue receiving slot is configured to slidably receive a tongue of the second interlocking member.

In some example embodiments, interlocking member of claim 11, further comprises a radio frequency identification (RFID) chip.

In some example embodiments, the flexible band is a flexible strip of material.

In some example embodiments, the tongue further includes a tongue biasing member on a front surface of the tongue extending away from the shell.

According to another aspect of the inventive concept, provided is a clasp configured to permanently secure a flexible band, comprising first and second interlocking members and a Bluetooth® communication device secured to or integral with at least one of the first and second interlocking members. (Bluetooth® is a registered trademark of Bluetooth SIG, Kirkland, Wash.) When interlocked, the first and second interlocking members define a path from one side of the clasp to an opposite side of the clasp through

6

which the flexible band passes such that the flexible band extends through a first opening in the one side of the clasp and a second opening in the opposite side of the clasp and the flexible band is compressed by and between the first and second interlocking members.

In some example embodiments, the Bluetooth communication devices is maintained by a holder that is secured to or integral with at least one of the first and second interlocking members.

In some example embodiments, at least one of the first and second interlocking members comprises a shell including a base, a tongue extending from the base in parallel with the shell, including at least one tongue protrusion extending from a tongue back surface toward the shell, a tongue receiving slot defined between the tongue and the shell, and within which the tongue protrusion extends, and at least one hook and at least one recess, each recess configured to receive a hook from another interlocking member.

In some example embodiments, at least one of the first and second interlocking members comprises a wall configured to prevent external access to the hook received within the recess.

In some example embodiments, when interlocked, the clasp defines an internal serpentine path between the tongues that compresses and secures the flexible band.

In some example embodiments, the at least one hook consists of two hooks and the at least one recess consists of two recesses configured to permanently receive the two hooks of the other interlocking member.

In some example embodiments, each hook comprises an angled side configured to facilitate insertion into a corresponding recess and a stop side configured to prohibit removal of the hook from the corresponding recess.

In some example embodiments, the at least one hook is at least one outwardly projecting protrusion of the tongue and the at least one recess is formed in outer portions of the shell.

In some example embodiments, each shell comprises an inner surface opposite the tongue and forming a portion of the tongue receiving slot and at least two ribs extending from the inner surface and forming opposing sides of the tongue receiving slot, wherein the tongue of each of the first and second interlocking members is configured to slidably engage the tongue receiving slot of the other interlocking member.

In some example embodiments, the tongue of at least one of the first and second interlocking members further includes a tongue biasing member on a front surface of the tongue extending away from the shell.

In some example embodiments, at least one of the first and second interlocking members comprises a radio frequency identification (RFID) chip.

In some example embodiments, the flexible band is a flexible strip of material.

In some example embodiments, the first and second interlocking members are identical.

According to another aspect of the inventive concept, provided is an interlocking member forming a portion of a clasp configured to secure a band, the interlocking member comprising a shell including a base and a Bluetooth communication device secured to or integral with the shell. The interlocking member is configured to interlock with a second interlocking member to form a clasp configured to permanently secure a flexible band passing through the clasp from one side to an opposite side, wherein a portion of the flexible band is compressed.

In some example embodiments, the Bluetooth communication devices is maintained by a holder that is secured to or integral with the shell.

In some example embodiments, when interlocked, the clasp defines an internal serpentine path between the tongues that compresses and secures the flexible band.

In some example embodiments, the interlocking member further comprises a tongue extending from the base in parallel with the shell, including at least one tongue protrusion extending from a tongue back surface toward the shell, a tongue receiving slot defined between the tongue and the shell, and within which the tongue protrusion extends, and at least one hook and at least one recess, each recess configured to receive a hook from another interlocking member and having a wall configured to prevent external access to the hook received within the recess.

In some example embodiments, the at least one hook consists of two hooks and the at least one recess consists of two recesses configured to permanently receive two hooks of the second interlocking member.

In some example embodiments, each hook comprises an angled side configured to facilitate insertion into a corresponding recess of the second interlocking member and a stop side configured to prohibit removal of the hook from the corresponding recess of the second interlocking member.

In some example embodiments, the at least one hook is at least one outwardly projecting protrusion of the tongue and the at least one recess is formed in outer portions of the shell.

In some example embodiments, the shell comprises an inner surface opposite the tongue and forming a portion of the tongue receiving slot and at least two ribs extending from the inner surface and forming opposing sides of the tongue receiving slot.

In some example embodiments, the tongue receiving slot is configured to slidably receive a tongue of the second interlocking member.

In some example embodiments, the tongue further includes a tongue biasing member on a front surface of the tongue extending away from the shell.

In some example embodiments, the interlocking member further comprises a radio frequency identification (RFID) chip.

In some example embodiments, the flexible band is a flexible strip of material.

#### BRIEF DESCRIPTION OF THE DRAWINGS

The foregoing and other features and advantages of embodiments of the present inventive concept will be apparent from the more particular description of embodiments of the inventive concept, as illustrated in the accompanying drawings in which like reference characters refer to the same elements throughout the different views. The drawings are not necessarily to scale, emphasis instead being placed upon illustrating the principles of the inventive concept in the drawings.

FIG. 1A is an illustrative perspective view of an interlocking member, as one of two interlocking members used to form a clasp, according to an example embodiment of the inventive concept. FIGS. 1B and 1C are different top oblique views of the interlocking member of FIG. 1A. FIG. 1D is an oblique side view of the interlocking member of FIGS. 1A through 1C, according to an example embodiment of the inventive concept.

FIGS. 2A through 2C show different views of the interlocking member of FIGS. 1A-1D having a band disposed therein, according to an example embodiment of the inven-

tive concept. FIG. 2A shows a perspective view of a band disposed within the interlocking member of FIG. 1A. FIG. 2B shows a top view of the interlocking member of FIG. 2A and FIG. 2C shows a side view of the interlocking member of FIG. 2A, according to an example embodiment of the inventive concept.

FIGS. 3A and 3B are illustrative perspective views of a clasp comprising two interlocking members, according to an example embodiment of the present inventive concept. FIG. 3A shows the clasp in an unassembled form while FIG. 3B shows the clasp in an assembled form with the two interlocking members locked together. FIG. 3C is a cross-sectional perspective view of the clasp of FIG. 3B taken along line A-A', according to an example embodiment of the present inventive concept. FIG. 3D is a side view of the clasp of FIG. 3B, according to an example embodiment of the present inventive concept. FIG. 3E is a cross-sectional oblique view of the clasp having a flexible band within the clasp of FIG. 3B taken along line B-B' at a different angle from FIG. 3C, according to an example embodiment of the present inventive concept.

FIGS. 4A and 5A are illustrative front views of an interlocking member of a clasp having a passive radio frequency identification (RFID) chip, according to an example embodiment of the inventive concept. FIGS. 4B and 5B are cross-sectional oblique views of the interlocking members of FIGS. 4A and 5A, respectively, forming part of a clasp that is cut along line A-A' as in FIG. 3A, according to an example embodiment of the inventive concept.

FIGS. 6A and 7A are illustrative unassembled views of two interlocking members of a clasp incorporating an active RFID chip, according to an example embodiment of the inventive concept. FIGS. 6B and 7B are cross-sectional oblique views of the assembled interlocking members of FIGS. 6A and 7A, respectively, forming part of a clasp that is cut along line A-A' as in FIG. 3A, according to an example embodiment of the inventive concept.

FIG. 8A is an illustrative front view of an alternative embodiment of an interlocking member of a clasp, according to an example embodiment of the present inventive concept. FIG. 8B is an illustrative rear view of the interlocking member of FIG. 8A, according to an example embodiment of the inventive concept. FIG. 8C shows a top view of the interlocking member of FIG. 8A. FIG. 8D is a cross-sectional side view of the interlocking member of FIG. 8A taken along line 8D-8D, according to an example embodiment of the present inventive concept. FIG. 8E is a side view of the interlocking member of FIG. 8A, according to an example embodiment of the inventive concept. FIG. 8F is a cross-sectional elevated view of the interlocking member of FIG. 8E taken along line 8F-8F, according to an example embodiment of the present inventive concept.

FIG. 9 shows an embodiment of a clasp including Bluetooth communications capability, according to an example embodiment of the present inventive concept.

FIGS. 10A and 10B are figures showing an embodiment of components of the clasp of FIG. 9.

#### DETAILED DESCRIPTION

The foregoing and other objects, features and advantages of the embodiments of inventive concept will be apparent from the more particular description of embodiments of inventive concept, as illustrated in the accompanying drawings. The drawings are not necessarily to scale, emphasis instead being placed upon illustrating the principles of the inventive concept in the drawings.

The terminology used herein is for the purpose of describing particular embodiments and is not intended to be limiting of the inventive concept. As used herein, the singular forms “a,” “an” and “the” are intended to include the plural forms as well, unless the context clearly indicates otherwise. It will be further understood that the terms “comprises,” “comprising,” “includes” and/or “including,” when used herein, specify the presence of stated features, integers, steps, operations, elements, and/or components, but do not preclude the presence or addition of one or more other features, integers, steps, operations, elements, components, and/or groups thereof.

It will be understood that, although the terms first, second, third etc. may be used herein to describe various limitations, elements, components, regions, layers and/or sections, these limitations, elements, components, regions, layers and/or sections should not be limited by these terms. These terms are only used to distinguish one limitation, element, component, region, layer or section from another limitation, element, component, region, layer or section. Thus, a first limitation, element, component, region, layer or section discussed below could be termed a second limitation, element, component, region, layer or section without departing from the teachings of the present application.

It will be further understood that when an element is referred to as being “on” or “connected” or “coupled” to another element, it can be directly on or above, or connected or coupled to, the other element or intervening elements can be present. In contrast, when an element is referred to as being “directly on” or “directly connected” or “directly coupled” to another element, there are no intervening elements present. Other words used to describe the relationship between elements should be interpreted in a like fashion (e.g., “between” versus “directly between,” “adjacent” versus “directly adjacent,” etc.). When an element is referred to herein as being “over” another element, it can be over or under the other element, and either directly coupled to the other element, or intervening elements may be present, or the elements may be spaced apart by a void or gap.

In accordance with various aspects of the inventive concept, provided is a clasp that may be used with any number of flexible bands, such as standard polyester product identification bands. The clasp may be used with various types of identification bands, straps, bracelets, anklets, or the like. The clasp may be used in various types of settings, medical facilities (for example, hospitals), nursing homes, paid entrance venues (for example, clubs, concerts, sporting events, museums), schools and universities, member only venues, and secure locations, as examples. The clasp may add an additional layer of security for use in facilities where the subject may not cooperate, for example. Examples of such facilities include: mental health facilities, lock-up facilities, detention centers, and prisons.

The clasp may be used, as an example, with straps or wrist bands that include Valéron® Strength Films, which is a flexible cross laminated high strength polyethylene film. The cross laminated high strength polyethylene film may be treated with polyester on both sides to protect the strap from heat. A coating on the cross laminated high strength polyethylene film may be water proof and scratch proof in order to protect the information stored on the strap.

In example embodiments, the clasp is easy to use, able to be put on a strap or wrist band without the use of tools, very difficult or substantially impossible to open without tools or breakage, and not able to be used as a weapon. It also is, preferably, comfortable and unobtrusive when worn.

The clasp described herein may be used to bind any two flat ribbon like materials without any destruction of the bound materials. For example, the clasp described herein may bind two ribbons containing fiber optics without destroying the integrity of the optics within.

Other possible applications of the example embodiments include providing clasps for security seals for shipping, trucking and railway containers. In one example embodiment, the clasps may be used for labels for shipping containers or as a seal or tamper indicator for a door of such a container, such that the seal would need to be broken (or cut) to open the door. In another example embodiment, the clasps may be used to attach ribbons to packages. In another example embodiment, the clasps may be used to create a belt or to cinch clothing.

In various embodiments, the clasp of the present invention includes two identical or substantially identical interlocking members that connect to secure and enclose a portion of a strap, band, ribbon, or wrist band. In such cases, any two interlocking members can be used to form a clasp, such that the user need not be concerned with getting two different parts. For example, a package of 100 interlocking members would yield 50 clasps, no matter which two interlocking members were taken from the bag, in a preferred embodiment.

In an example embodiment, the clasp uses four positive latching mechanisms, each of two interlocking members having two male and two female mechanisms configured to engage with the corresponding mechanisms of the other interlocking member. A positively locked and secure clasp may be provided with the application of some physical force that forces each male mechanism into the corresponding female mechanism as the two interlocking members are pressed together to form a clasp. That is, no tools are required to connect the two interlocking members. In addition, an example embodiment of the clasp is designed to be a single use device, so no provision is made to disengage it once locked. This provides security as it cannot be removed by any party. Therefore, in preferred embodiments, the two interlocking members are permanently locked together.

The clasp of the example embodiments of the present inventive concept when used with ID bands (for example, patient or inmate ID bands), as an example, may cover an adhesive flap overlapped and adhered onto the band to make the flap inaccessible to the wearer or others. The clasp is positioned to cover the flap, as the two interlocking members are locked together; internal ribs engage the band and lock the clasp into that position so that the clasp cannot be slid sideways to gain access to the bands adhesive flap. In this manner, a seam flap overlapped onto the band may be permanently secured within the clasp.

To ease alignment when affixing the clasp to the strap or band, internal alignment pins guide the two interlocking members into place, making it easy to apply the clasp.

FIG. 1A is an illustrative front view of an interlocking member, as one of two interlocking members used to form a clasp, according to an example embodiment of the inventive concept. FIGS. 1B and 1C are different top oblique views of the interlocking member of FIG. 1A. FIG. 1D is an oblique side view of the interlocking member of FIG. 1A, according an example embodiment of the inventive concept.

FIGS. 2A through 2C show different views of the interlocking member of FIGS. 1A-1D having a band disposed therein, according to an example embodiment of the inventive concept. FIG. 2A shows a perspective view of a band disposed within the interlocking member of FIG. 1A. FIG. 2B shows a top view of the interlocking member of FIG. 2A

11

and FIG. 2C shows a side view of the interlocking member of FIG. 2A, according to an example embodiment of the inventive concept.

FIGS. 3A and 3B are illustrative perspective views of a clasp comprising two interlocking members, according to an example embodiment of the present inventive concept. FIG. 3A shows the clasp in an unassembled form, while FIG. 3B shows the clasp in an assembled form with the two interlocking members locked together. FIG. 3C is a cross-sectional oblique view of the clasp of FIG. 3B taken along line A-A', according to an example embodiment of the present inventive concept. FIG. 3D is a side view of the clasp of FIG. 3B, according to an example embodiment of the present inventive concept. FIG. 3E is a cross-sectional oblique view of the clasp having a flexible band within the clasp of FIG. 3B taken along line B-B' at a different angle from FIG. 3C, according to an example embodiment of the present inventive concept.

FIGS. 1A-1C show an example embodiment of an interlocking member 10 that can be used as one of two interlocking members that combine to form a clasp 100 within which a flexible band 20 may be secured, see also FIGS. 3A-3E. In these embodiments, the two interlocking members used to form a clasp may be structurally the same, or substantially the same. That is, two interlocking members used to form a clasp can be indistinguishable, apart from any aesthetic features, such as color, texture, or structural differences not involving the interlocking mechanisms that cause the two interlocking members to permanently lock together. In various embodiments, the clasp may be structured to accommodate available 1" bands, but in other embodiments the clasp could be structured to fit ¾" and ½" bands, as examples. There are no inherent limitations on the scaling or uses of the clasp and bands.

A flexible band of material (or "flexible band", or "band") 20, for example, a strap or wrist band, may be waterproof, chemical resistant, and scratchproof. In addition, the band 20 may be stretch proof and tear proof so that it needs to be cut off to be removed. The band 20 may include at least one of a strip of cables, plastic, and fibers, as examples.

In the example embodiment, the clasp is arranged to enclose and prevent access to a closure region of the band 20. The closure region can be a seam or an area where two portions of a least one band overlap. In FIGS. 3A-3D, for example, the interlocking member 10 is shown with an overlapped area of two ends of flexible band 20 disposed therein.

The clasp includes first and second interlocking members 10. The first and second interlocking members 10 are identically formed pieces in this embodiment, but need not be in others. Each interlocking member 10 includes an outer shell 12 having interlocking recesses 18 formed therein. Each interlocking member 10 also includes a tongue 14 having outwardly projecting interlocking hooks 16 and a tongue receiving slot 22 formed between the tongue 14 and the outer shell 12.

In this embodiment, opposite tongue 14 there is an inner surface 23 of shell 12 forming a portion of the tongue receiving slot 22. The inner surface 23, as illustrated in FIGS. 1B and 1C, includes internal ribs 24 protruding from the inner surface 23 and forming opposing sides of the tongue receiving slot 22. In this embodiment, ribs 24 are spaced apart at a distance that is slightly greater than the width of the tongue 14 to be received in tongue receiving slot 22. Preferably, insertion of tongue 14 in tongue receiv-

12

ing slot 22 causes a tight fit of band 20 therein, that is, a fit that grips and compresses band 20 to render band 20 substantially immovable.

As illustrated in FIGS. 1C and 1D, the tongue 14 includes at least one protrusion 26 extending from a tongue back surface 13 and forming a portion of the tongue receiving slot 22. The protrusion 26 is configured to reduce or prevent sliding of the band 20 between the opposing interlocking members 10 when interlocked. In this embodiment, the protrusion 26 is centered in the rear of tongue 14 so that protrusions of two combined interlocking members compress band 20. But in other embodiments there may be more than one protrusion on one or both tongues of the two combined interlocking members, and the protrusion may not be centered. Each interlocking member 10 includes a base 15 from which the outer shell 12 and tongue 14 extend substantially in parallel. Within the base 15, a channel 11 is formed, at the bottom of the receiving slot 22.

In this embodiment, interlocking member 10 includes two interlocking hooks 16 and two interlocking recesses 18. In this embodiment, recesses 18 are shown as being open, creating a window through which hooks 16 can be seen when two interlocking members are combined. However, such a window is not essential, that is, recess 18 could be completely internal to the clasp and not externally visible. Each of the interlocking hooks 16 of a first interlocking member is arranged to engage and interlock with a corresponding one of the interlocking recesses 18 of a second interlocking member and each of the interlocking hooks 16 of the second member is arranged to interlock with one of the interlocking recesses 18 of the first interlocking member, so as to prevent movement between the interlocking members when interlocked. Therefore, the interlocking hooks 16 of each of the interlocking members 10 are configured to engage and snap into corresponding interlocking recesses 18 of the opposing interlocking member, securing and interlocking the two members with each other as shown in FIGS. 2A and 3A.

In the preferred embodiment, the interlocking hooks 16 are not spring-loaded or otherwise displaceable so that the interlocking members 10 are not releasable once engaged, even with a tool. As illustrated in FIGS. 1A through 1D, each of the interlocking hooks 16 includes an angled member 17 configured to facilitate insertion into a corresponding interlocking recess 18 and a stop member 19 configured to prohibit removal of the interlocking hook from the corresponding interlocking recess, see, for example, FIG. 3A.

As illustrated in FIGS. 2A through 2C, the first interlocking member 10 is shown with the flexible band 20 disposed between the tongue 14 and internal ribs 24 of the first interlocking member 10.

In an example embodiment, as illustrated in FIGS. 2B and 3E, a portion of the band 20 is positioned within the interlocking member 10 within channel 11. As such, band 20 passes by and contacts the tongue 14, opposing internal ribs 24, and protrusions 26 in a serpentine-like manner, i.e., having a non-straight path through the clasp that turns one way and another in response to the combination of ribs, protrusions and recesses within the clasp. The primary cause for this manner of the shape of band 20 within channel 11 is that protrusion 26 extends from tongue 14 partially in to the channel 11, as do ribs 24 on the opposite side of channel 11. As a result, a straight line path through the channel 11 does not exist for band 20, which bends around protrusions 26 and internal ribs 24 when disposed in channel 11. Accordingly, the band 20 is held in place when two interlocking members are combined, which substantially prevents the

13

band 20 from sliding through the clasp. The compression imparted on the band by the structural elements that cause the serpentine-like path of the band 20 prevent the band 20 from sliding in the left and right directions within the clasp.

As illustrated in FIG. 3B, the clasp includes relatively smooth surfaces with rounded edges so as to improve comfort to an individual wearing the strap/clasp and to help avoid injury from the clasp while being worn. Such relatively smooth surfaces and rounded corners are not essential to the inventive concept, however.

Referring to FIGS. 3A-3E, a clasp 100 is shown formed of two interlocking members 10, 10', having band 20 secured therein.

In various embodiments, the clasp 100 may be constructed of plastic, resin, metal, or similar materials. In various embodiments, the clasp may be molded or generated from a single material that is sufficiently flexible to permit the interlocking hooks 16 to flex/snap/engage into the interlocking recesses 18, while being strong enough to prevent easy breakage or removal of the clasp 100. In various embodiments, the clasp 100 may be constructed of Acrylonitrile Butadiene Styrene (ABS). Depending on the intended use, a softer plastic with characteristics similar to that of Poly Olefins, for example, would be avoided with respect to at least the outer protective shell of the clasp, that is, in cases where the clasp functions as a secure device.

The clasp 100 of the example of embodiments of the present inventive concept includes two identical or substantially identical interlocking members 10, 10' which may be put together with the force of a hand, but do not come apart. In addition, the clasp 100 engages the band 20 in such a manner that no holes or rivets are produced in the band which could weaken the band. The clasp 100 includes four attachment points which substantially prevent movement between the interlocking members when interlocked. The clasp 100 includes interlocking hooks 16, 16' which are not spring-loaded so that the interlocking members are not releasable once engaged, even with a tool, see, for example, FIG. 3A. The clasp 100 has smooth edges, that is, no sharp edges, so that the clasp cannot be turned into a weapon.

When the first and second interlocking members 10, 10' are interlocked or engaged, the tongue 14 of one interlocking member 10 fits within the tongue receiving slot 22' of the other interlocking member 10' and the hooks 16 of one interlocking member 10 engage the interlocking recesses 18' of the other interlocking member 10', so as to prevent disengagement of the interlocking members 10, 10'. When the first and second interlocking members 10, 10' are interlocked, a portion of the band 20 is disposed between and in parallel with the tongues and the outer shells 12, 12' of the first and second interlocking members 10, 10'.

FIG. 3A demonstrates how first and second interlocking members 10, 10' combine to form clasp 100, in accordance with the example embodiment. The band 20 is disposed in channel 11 of first interlocking member 10, then second interlocking member 10' is placed over band 20 such that tongue 14 of first interlocking member 10 inserts into tongue receiving slot 22' of the second interlocking member 10' and tongue 14' of the second interlocking member 10' inserts into tongue receiving slot 22 of the first interlocking member 10. As the two interlocking members are pressed together, hooks 16 of the first interlocking member 10 are irremovably forced into the corresponding recesses 18' of the second interlocking member 10' and hooks 16' of the second interlocking member 10' are irremovably forced into recesses 18 of the first interlocking member 10, as is shown in the side view of FIG. 3D.

14

FIG. 3B shows the interlocking members 10, 10' combined to form clasp 100 and FIG. 3C shows a cross-section of clasp 100 taken along line A-A' of FIG. 3B. In FIG. 3C band 20 is engaged and compressed between protrusions 26, 26' of the first and second interlocking members 10, 10', respectively. Similarly, band 20 may also be compressed between opposing ribs 24, 24' of first and second interlocking members 10, 10', respectively.

FIG. 3E is a cross-sectional perspective view of clasp 100 having flexible band 20 secured therein, taken along line B-B' in FIG. 3B. As is shown in FIG. 3E, band 20 is secured in a serpentine-like path through clasp 100, similar to what is shown in FIG. 2B. As is apparent from FIG. 3E, near the base 15 of interlocking member 10, tongue 14' of interlocking member 10' is pushed toward the outside of receiving slot 22 from the force of the more rigid base 15 (from which tongue 14 extends) applied to a distal end of tongue 14'. Thus, the serpentine-like bending of band 20 shown in FIG. 2B is maintained when interlocking members 10, 10' are combined. The same aspects would be realized at base 15' (not shown) of interlocking member 10'. Similarly, base 15' would push tongue 14 toward the outside of receiving slot 22', when band 20 is compressed between the interlocking members 10, 10'. Therefore, in this embodiment, the serpentine-like bending of band 20 at base 15' of interlocking member 10' would be opposite that shown for base 15 of interlocking member 10.

In other embodiments, the clasp may include other types of devices and/or sensors embedded therein, for example, a RFID chip, wander sensors, medical monitoring devices and GPS tracking devices. The interlocking members that form such a clasp may be as otherwise described above, that is, with respect to FIGS. 1A-1D, 2A-2C, and 3A-3E.

FIGS. 4A and 5A are rear views of an interlocking member of a clasp having a passive radio frequency identification (RFID) chip, according to an example embodiment of the inventive concept. FIGS. 4B and 5B are cross-sectional oblique views of the interlocking members of FIGS. 4A and 5A, respectively, forming part of a clasp that is cut along line A-A' as in FIG. 3A, according to an example embodiment of the inventive concept.

In FIGS. 4A and 5A, the interlocking members 30 are similar to the interlocking members 10, 10', as discussed above. The interlocking members 30 of FIGS. 4A, 4B, 5A and 5B further include a passive RFID chip 32. The passive RFID chip 32 relies on a reader of the RFID chip as its power source, in this embodiment.

In FIGS. 4A and 4B, the RFID chip 32 may be coupled to the interlocking member 30 by adhesive, such as glue. In FIGS. 5A and 5B, a pocket 34 is molded onto the interlocking member 30 between one of the internal ribs 24 and the outer shell 12 and the RFID chip 32 is inserted therein.

In FIGS. 4A, 4B, 5A and 5B, the RFID chip 32 is located between one of the internal ribs 24 and the outer shell 12. In FIGS. 4A and 4B, the RFID chip 32 is located between the inner surface 23 and a surface of the internal ribs 24 which interfaces with the band 20. In FIGS. 5A and 5B, the pocket 34 is located between the inner surface 23 and a surface of the internal ribs 24 which interfaces with the band 20.

FIGS. 6A and 7A are illustrative views of two interlocking members of a clasp in unassembled form, with at least one interlocking member in each figure having an active RFID chip, according to an example embodiment of the inventive concept. FIGS. 6B and 7B are cross-sectional oblique views of the interlocking members of FIGS. 6A and 7A, respectively, assembled to form the clasp, with the cross section cut along line A-A' as in FIG. 3A, respectively, according to an

15

example embodiment of the inventive concept. Active RFID chips use internal batteries to power their circuits, in this embodiment.

FIGS. 6A and 6B illustrate both an active RFID chip 42 and a battery 44 being formed on a single side of a clasp 40. That is, the active RFID chip 42 and the battery 44 are only formed on one of the interlocking members of the clasp, namely clasp 40. The active RFID chip 42 and the battery 44 are coupled by circuitry 46. Pockets 48 are molded onto the interlocking member 40 between each of the internal ribs 24 and the outer shell 12 and the RFID chip 42 and the battery are inserted therein, respectively. In FIGS. 6A and 6B, the pockets 48 are located between the inner surface 23 and a surface of the internal ribs 24 which interfaces with the band 20.

A switch is formed on an external face of the interlocking member such that the active RFID chip 42 is activated when the interlocking members are engaged or interlocked. In an alternative embodiment, the active RFID chip 42 is activated prior to the interlocking members being engaged or interlocked.

FIGS. 7A and 7B illustrate an active RFID chip 54 being formed on one of the interlocking members of the clasp, namely, interlocking member 50, and a battery 60 being formed on the other of the interlocking members of the clasp, namely, interlocking member 52. The active RFID chip 54 is coupled to an exposed contact 58 by circuitry 56. The exposed contact 58 is on the tongue 14 of the interlocking member 50. In an example embodiment, the contact 58 is formed on the top of the tongue 14.

The battery 60 is inserted or molded into the plastic or other material of the interlocking member 52. In one example embodiment, the battery 60 is formed on the inner surface 23 of the interlocking member 52. In one example embodiment, the battery 60 is disk-shaped; however, the present inventive concept are not limited thereto. The battery 60 has an exposed contact thereon.

The exposed contact 58 on the tongue 14 will come in contact with the underside of the exposed contact on the battery 60 when the clasp is closed thereby activating the active RFID chip.

FIGS. 8A through 8F show an alternative embodiment of an interlocking member used to form a clasp, according to aspects of the inventive concept. Like the above embodiments, in a preferred embodiment, two identical, or substantially identical, interlocking members 80 can be press fit together to permanently engage to form the clasp, with a band secured therein between the two interlocking members 80. In some embodiments, it may be preferable to have an overlapping portion of the band secured within the clasp to mitigate against peeling the band apart. In accordance with this embodiment, improved security and resistance to tampering are provided. Additionally, or alternatively, improved band gripping can also be realized through this embodiment.

For example, improved security can be provided by preventing external access to the hooks 16 of each interlocking member that engage the recesses 18 of the other interlocking member. Additionally, an element may be included in the clasp to provide greater compressive force to a band maintained within the clasp. Such additional compressive force may be imparted, for example, by providing greater contact area between internal components of the clasp and the band maintained therein and/or the internal components of the clasp can be formed to provide greater compressive force to the band. The greater compressive force reduces the possibility of slippage of the band within

16

the clasp, e.g., to avoid displacing the band to expose the overlapped band portion originally disposed within the clasp.

FIG. 8A is an illustrative front view of an alternative embodiment of an interlocking member of a clasp, according to an example embodiment of the present inventive concept. FIG. 8B is an illustrative rear view of the interlocking member of FIG. 8A, according to an example embodiment of the inventive concept. FIG. 8C shows a top view of the interlocking member of FIG. 8A. FIG. 8D is a cross-sectional side view of the interlocking member of FIG. 8A taken along line 8D-8D, according to an example embodiment of the present inventive concept. FIG. 8E is a side view of the interlocking member of FIG. 8A, according to an example embodiment of the inventive concept. FIG. 8F is a cross-sectional elevated view of the interlocking member of FIG. 8E taken along line 8F-8F, according to an example embodiment of the present inventive concept.

FIG. 8A shows a front view of a single interlocking member. This view shows an outer shell portion 12 of the interlocking member. From this view, interlocking member 80 is substantially similar to the interlocking members of the other embodiments disclosed herein.

FIGS. 8B, 8C, 8D, and 8E show one difference of interlocking member 80 of this alternative embodiment when compared to the interlocking member embodiments described in connection with FIGS. 1A-1D above, for example. In this embodiment, interlocking member 80 may include a tongue biasing member in the form of at least one raised portion, or bump 81, formed on a front surface 13' of tongue 14, opposite tongue back surface 13. Bump 81 protrudes up from the tongue front surface 13', opposite rib 26 on the tongue back surface 13, for example. The interlocking member 80 includes internal ribs 24 protruding from the inner surface 23 and forming opposing sides of a tongue receiving slot 22. Tongue 14 has a width that is no greater than a width of the tongue receiving slot 22. Similarly, bump 81, which may be considered to form part of tongue 14, has a width that is no greater than a width of the tongue receiving slot 22.

In the embodiment of FIGS. 8B, 8C, 8D and 8E, the bump 81 extends between the base 15 and a top of the tongue 14. The bump 81 can include an inclined portion 82 that extends at an angle from the tongue front surface 13', beginning at or near a top portion of the tongue 14, toward the base 15. The inclined portion 82 may advantageously provide a smooth coupling of two interlocking members 80 when they are press fit together to form a clasp. The bump 81 can also include an intermediate portion formed between the inclined portion 82 and the base 15. The intermediate portion can be a flat portion 83 that extends from the inclined portion 82 to or near the base 15. In this embodiment, the top surface of the flat portion 83 extends in parallel to the top surface of the tongue 14. The top surface of the flat portion 83 has a predetermined and uniform height above the tongue front surface 13', which does not extend beyond an outer surface of the base 15.

While the bump 81 in this embodiment is shown as a flat portion having uniform thickness, in other embodiments, the bump 81 can take the form of a discontinuous set of protrusions collectively forming bump 81. In some embodiments, the set of protrusions could be arranged vertically, horizontally, crosswise, or some combination thereof. In other embodiments the set of protrusions can take the form or include prongs extending from the tongue front surface 13'.

17

While bump **81** is shown to include the inclined portion **82** and the flat portion **83** in the depicted embodiment, in other embodiments, bump **81** could include the inclined portion **82**, but not the flat portion **83**, or, as an alternative, bump **81** could include the flat portion **83**, but not the inclined portion **82**.

In still other embodiments, the bump **81** need not extend to or near base **15**. That is, the bump **81** may only extend partially down the tongue **14**. In still other embodiments, the bump **81** could extend halfway or less down the tongue **14**.

Bump **81** biases the tongue **14** towards the band **20** (or center of the clasp) when one interlocking member **80** is mated with another interlocking member **80**, resulting in a greater applied force and a stronger hold of the band **20** therein. Accordingly, bump **81** provides a tighter fit between interlocking members such that it is more difficult to move a band compressed between two tongues of a two engaged interlocking members.

FIG. **8F** shows a cross-sectional view of the interlocking member **80**, exposing some of the internal structure of the apparatus. As with the other embodiments, interlocking member **80** includes two interlocking hooks **16** and two interlocking recesses **18**. Each of the interlocking hooks **16** includes an angled member **17** configured to facilitate insertion into a corresponding interlocking recess **18** and a stop member **19** configured to prohibit removal of the interlocking hook **16** from the corresponding interlocking recess **18**, see, for example, FIGS. **3A** and **8A**.

FIG. **8F** also shows that the recess **18** includes a detent **21** configured to maintain the hook **16** of a corresponding interlocking member **80** within the recess **18** when two interlocking members are press fit together. Detent **21** also forms part of the recesses **18** of the embodiments above. When press fit together to form a clasp, the detent **21** of recess **18** of one interlocking member abuts against the stop member **19** of the hook **16** of the other interlocking member. A height  $h$  of the detent **21** is chosen to make a snug fit with stop **19**, so the two interlocking members are tightly press fit and maintained together.

Each detent **21** also includes an angled wall **25** that receives the angled member **17** of a hook **16** of another interlocking member **80**. The angled wall **25** of the detent **21** and the angled member **17** of the hook **16** allow the hook to be wedged into the recess as the two interlocking members are press fit together. In this embodiment, either the recess **18** or hook **16** or both have sufficient give to enable the press fit, with the hook **16** and recess having their original shapes once press fit together so that the detent **21** and stop member **19** are abutted to maintain the hook **16** in the recess **18**.

Additionally, in this embodiment, recesses **18** are closed off by closed wall **85**, such that hooks **16** cannot be seen or accessed when two interlocking members are combined. Such a feature was indicated as an option with respect to the interlocking member **10** of FIGS. **1A** through **1D**, as an example. Closed wall **85** yields recesses **18** that are completely internal to the clasp and not externally visible or otherwise accessible. In this manner, access to the hooks **16** and recesses **18** that maintain the two interlocking members of the clasp together is denied, thereby providing greater security and tamper-resistance for the clasp.

FIG. **9** shows an embodiment of a clasp **900** including Bluetooth communications capability. FIGS. **10A** and **10B** are figures showing an embodiment of components of the clasp of FIG. **9**.

The clasp **900** includes first interlocking member **10**, **80** (described above) and a second interlocking members **910**. Interlocking member **910** can be substantially the same as

18

interlocking members **10** and/or **80** discussed above with respect to various features and structures for securing together the interlocking members with a band secured therein that passes through a channel **911** formed within the clasp **900**. Preferably, interlocking member **910** has at least one hook and at least one recess, where each recess is configured to receive a hook from another interlocking member and has a wall configured to prevent external access to the hook received within the recess, such as interlocking member **80**.

In this embodiment, the clasp **900** includes a communication device **920** having wireless technology meeting the Bluetooth® standards, currently defined by IEEE 802.15.1, which is a standard for short-range wireless interconnection used by mobile phones, computers, and other electronic devices and referred to as "Bluetooth." Therefore, communication device **920** may be referred to as Bluetooth communication device **920**. In various embodiments, the Bluetooth communication device **920** can be integral with, embedded within, or coupled to an outer shell **912** of the interlocking member **910**. In various embodiments, the Bluetooth device **920** can be adhered to the outer shell **912** of the interlocking member **910**. In various embodiments, the Bluetooth communication device **920** can be a sticker beacon **924** having a round shape and includes a 1 piece CR2016 coin battery. In various embodiments the beacon **924** can be maintained by a holder **922** secured to or integral with the outer shell **912**.

In various embodiments, the Bluetooth communication device **910** can take the form of or include a Beacon, an iBeacon, or a mini-Beacon, such as i9 Pilot MiniBeacon by Minew Technologies. The device **910** may broadcast 2.4 GHz radio signals at regular and adjustable intervals and can be heard and interpreted by iOS and Android BLE-enabled devices that are equipped with many mobile applications. The device **910** may have adjustable transmission power levels and a transmission power range, for example, of -30 dBm to +4 dBm. The device **910** may include a password (lock/unlock parameters), may broadcast the encrypted data if needed and may include AES HW encryption.

While the inventive concept have been particularly shown and described with references to example embodiments thereof, it will be understood to those skilled in the art that various changes in form and details may be made herein without departing from the spirit and scope of the invention as defined in the appended claims.

What is claimed is:

1. A clasp configured to permanently secure a flexible band, comprising:

first and second interlocking members, wherein the first interlocking member includes an outer shell and the second interlocking member includes an outer shell different from the outer shell of the first interlocking member, the outer shell of the second interlocking member having an outer surface with a holder formed therein; and

a communication device having Bluetooth® capabilities maintained by the holder within the outer shell of the second interlocking member,

wherein, when interlocked, the first and second interlocking members define a path from one side of the clasp to an opposite side of the clasp through which the flexible band passes such that the flexible band extends through a first opening in the one side of the clasp and a second opening in the opposite side of the clasp and the flexible band is compressed by and between the first and second interlocking members.

19

2. The clasp of claim 1, wherein each of the first and second interlocking members comprises:

- a base defining an end of the outer shell;
- a tongue extending from the base in parallel with the outer shell, including at least one tongue protrusion extending from a tongue back surface toward the outer shell;
- a tongue receiving slot defined between the tongue and the outer shell, and within which the tongue protrusion extends; and
- at least one hook and at least one recess, each recess configured to receive a hook from another interlocking member.

3. The clasp of claim 2, wherein at least one of the first and second interlocking members comprises a wall configured to prevent external access to the hook received within the recess.

4. The clasp of claim 2, wherein, when interlocked, the clasp defines an internal serpentine path between the tongues that compresses and secures the flexible band and the holder of the communication device of the outer shell of the second interlocking member is not within the internal serpentine path.

- 5. The clasp of claim 2, wherein, the at least one hook consists of two hooks; and the at least one recess consists of two recesses configured to permanently receive the two hooks of the other interlocking member, wherein each hook comprises an angled side configured to facilitate insertion into a corresponding recess and a stop side configured to prohibit removal of the hook from the corresponding recess.

6. The clasp of claim 2, wherein: the at least one hook is at least one outwardly projecting protrusion of the tongue; and the at least one recess is formed in outer sides of the outer shell.

7. The clasp of claim 2, wherein each outer shell comprises: an inner surface opposite the tongue and forming a portion of the tongue receiving slot; and at least two ribs extending from the inner surface and forming opposing sides of the tongue receiving slot, wherein the tongue of each of the first and second interlocking members is configured to slidably engage the tongue receiving slot of the other interlocking member.

8. The clasp of claim 2, wherein the tongue of at least one of the first and second interlocking members further includes a tongue biasing member on a front surface of the tongue extending away from the outer shell.

9. The clasp of claim 1, wherein at least one of the first and second interlocking members comprises a radio frequency identification (RFID) chip.

10. An interlocking member forming a portion of a clasp configured to secure a band, the interlocking member comprising: an outer shell including a base; and

20

a communication device having Bluetooth® capabilities embedded within an outer surface of the outer shell, wherein the interlocking member is configured to interlock with a second interlocking member to form a clasp configured to permanently secure a flexible band passing through the clasp from one side to an opposite side, wherein a portion of the flexible band is compressed.

11. The interlocking member of claim 10, wherein, when interlocked, the clasp defines an internal serpentine path between the tongues that compresses and secures the flexible band and the communication device embedded within the outer surface of the outer shell is not within the internal serpentine path.

12. The interlocking member of claim 10, further comprising: a tongue extending from the base in parallel with the outer shell, including at least one tongue protrusion extending from a tongue back surface toward the outer shell; a tongue receiving slot defined between the tongue and the outer shell, and within which the tongue protrusion extends; and

at least one hook and at least one recess, each recess configured to receive a hook from another interlocking member and having a wall configured to prevent external access to the hook received within the recess.

13. The interlocking member of claim 12, wherein, the at least one hook consists of two hooks; and the at least one recess consists of two recesses configured to permanently receive two hooks of the second interlocking member, wherein each hook comprises an angled side configured to facilitate insertion into a corresponding recess of the second interlocking member and a stop side configured to prohibit removal of the hook from the corresponding recess of the second interlocking member.

14. The interlocking member of claim 12, wherein: the at least one hook is at least one outwardly projecting protrusion of the tongue; and the at least one recess is formed in outer sides of the outer shell.

15. The interlocking member of claim 12, wherein the outer shell comprises: an inner surface opposite the tongue and forming a portion of the tongue receiving slot; and at least two ribs extending from the inner surface and forming opposing sides of the tongue receiving slot.

16. The interlocking member of claim 12, wherein the tongue receiving slot is configured to slidably receive a tongue of the second interlocking member.

17. The interlocking member of claim 12, wherein the tongue further includes a tongue biasing member on a front surface of the tongue extending away from the outer shell.

18. The interlocking member of claim 10, further comprising: a radio frequency identification (RFID) chip.

\* \* \* \* \*